

## CATALOGUE

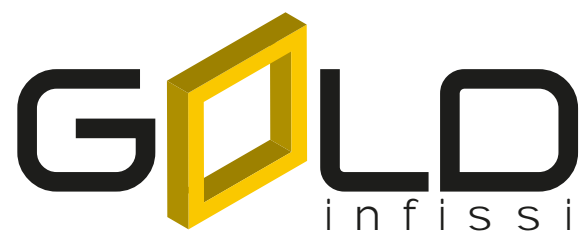

**Pre-fabricated buildings** • Aluminium and PVC fixtures  
Aluminium parts





**Pre-fabricated buildings** • Aluminium and PVC fixtures  
Aluminium parts

## About Us

The Company was founded in February 2011 to manufacture doors and windows for prefabricated buildings; right from the start, our purpose was to provide good value for money, flexible production and the highest level of quality.

Since 2012, our organisation has allowed us to reach a good level of service.

In 2013, we wanted to take a leap forward by investing in new profiles and new machines to improve our performance and increase productivity and penetration in the prefabricated housing industry while acquiring new customers.

The same year, we acquired customers for the creation of special details and personalised aluminium products, either with materials to be processed or supplied in full.

Our bold approach to improvement has rewarded us even in the following years, with a 50% increase in revenue and high levels of service and quality.

In 2016 we completed our range of products by investing in machines and equipment for the production of PVC fixtures for both industrial and residential use.

It is not up to us to set our next goals; we have to rely on the market and our customers, because our main goal is to meet their expectations and market demands.

### OUR MOTTOS

- Our youth is our strength
- Continuous improvement is part of our way of thinking
- Quality is the essence of our decisions
- Customers are our priority







# Pre-fabricated buildings • Aluminium and PVC fixtures

We manufacture aluminium and PVC doors and windows for prefabricated buildings, such as modular homes, bungalows and garages.



# CONTENTS

## 3000 SERIES

<b>Mod. 3000.01</b>	Single door with central crosspiece	10
<b>Mod. 3000.02</b>	Single door with reversible metal panel	11
<b>Mod. 3000.03</b>	Single door with metal panel	12
<b>Mod. 3000.04</b>	Sliding window	13
<b>Mod. 3000.05</b>	Bottom-hung window	14

## 3100 SERIES

<b>Mod. 3100.01</b>	Single door with central crosspiece	18
<b>Mod. 3100.02</b>	Double door with central crosspiece	19
<b>Mod. 3100.03</b>	Interior flush door	20
<b>Mod. 3100.04</b>	Exterior flush door	21
<b>Mod. 3100.05</b>	Double flush door	22
<b>Mod. 3100.06</b>	Sliding window	23
<b>Mod. 3100.07</b>	Outward-opening window	24
<b>Mod. 3100.08</b>	Outward-opening double window	25
<b>Mod. 3100.09</b>	Bottom-hung window	26
<b>Mod. 3100.10</b>	Double bottom-hung window	27

## 3200 SERIES

<b>Mod. 3200.01</b>	Single door with central crosspiece and skirting	30
<b>Mod. 3200.02</b>	Double door with central crosspiece and skirting	31
<b>Mod. 3200.03</b>	Sliding window	32
<b>Mod. 3200.04</b>	Sliding door with roller shutter	33
<b>Mod. 3200.05</b>	Tilt-and-turn window	34
<b>Mod. 3200.06</b>	Tilt-and-turn double window	35
<b>Mod. 3200.07</b>	Double window, with one fixed panel and one tilt-and-turn panel	36
<b>Mod. 3200.08</b>	Tilt-and-turn window with roller shutter	37
<b>Mod. 3200.09</b>	Tilt-and-turn double window with roller shutter	38
<b>Mod. 3200.10</b>	Double window, with one fixed panel and one tilt-and-turn panel, with roller shutter	39
<b>Mod. 3200.11</b>	Single window	40
<b>Mod. 3200.12</b>	Double window	41
<b>Mod. 3200.13</b>	Fixed window	42
<b>Mod. 3200.14</b>	Double fixed window	43
<b>Mod. 3200.15</b>	Gas-strut door	44
<b>Mod. 3200.16</b>	Air conditioner window	45
<b>Mod. 3200.17</b>	Fixed louver grill	46

# CONTENTS

## 3300 SERIES

<b>Mod. 3300.01</b>	R40 interior door with rounded door jamb	50
<b>Mod. 3300.02</b>	R40 exterior door	51
<b>Mod. 3300.03</b>	R40 bottom-hung door	52
<b>Mod. 3300.04</b>	R50 sliding window	53

## 4000 SERIES

<b>Mod. 4000.01</b>	Exterior door	56
<b>Mod. 4000.02</b>	Bottom-hung window	57
<b>Mod. 4000.03</b>	Tilt-and-turn window	58

## 5000 SERIES

<b>Mod. 5000.01</b>	Bottom-hung window	62
<b>Mod. 5000.02</b>	Double window, with one moveable and one fixed panel	63
<b>Mod. 5000.03</b>	Double sliding door	64
<b>Mod. 5000.04</b>	Sliding door with roller shutter	65
<b>Mod. 5000.05</b>	Tilt-and-turn window	66
<b>Mod. 5000.06</b>	Tilt-and-turn window with roller shutter	67
<b>Mod. 5000.07</b>	Double tilt-and-turn window	68
<b>Mod. 5000.08</b>	Double tilt-and-turn window with roller shutter	69
<b>Mod. 5000.09</b>	Double window, with one fixed panel and one tilt-and-turn panel	70
<b>Mod. 5000.10</b>	Double window, with one fixed panel and one tilt-and-turn panel, with roller shutter	71
<b>Mod. 5000.11</b>	Fixed window	72
<b>Mod. 5000.12</b>	Double fixed window	73

## COLOURS

Colour range	76
--------------	----

# 3000 SERIES

## DOORS

### TECHNICAL FEATURES

Large window

Good value for money

Rugged and durable with reinforced profiles

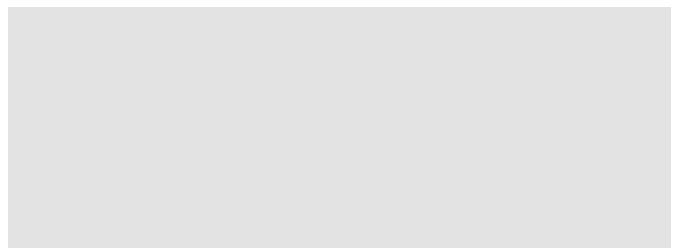
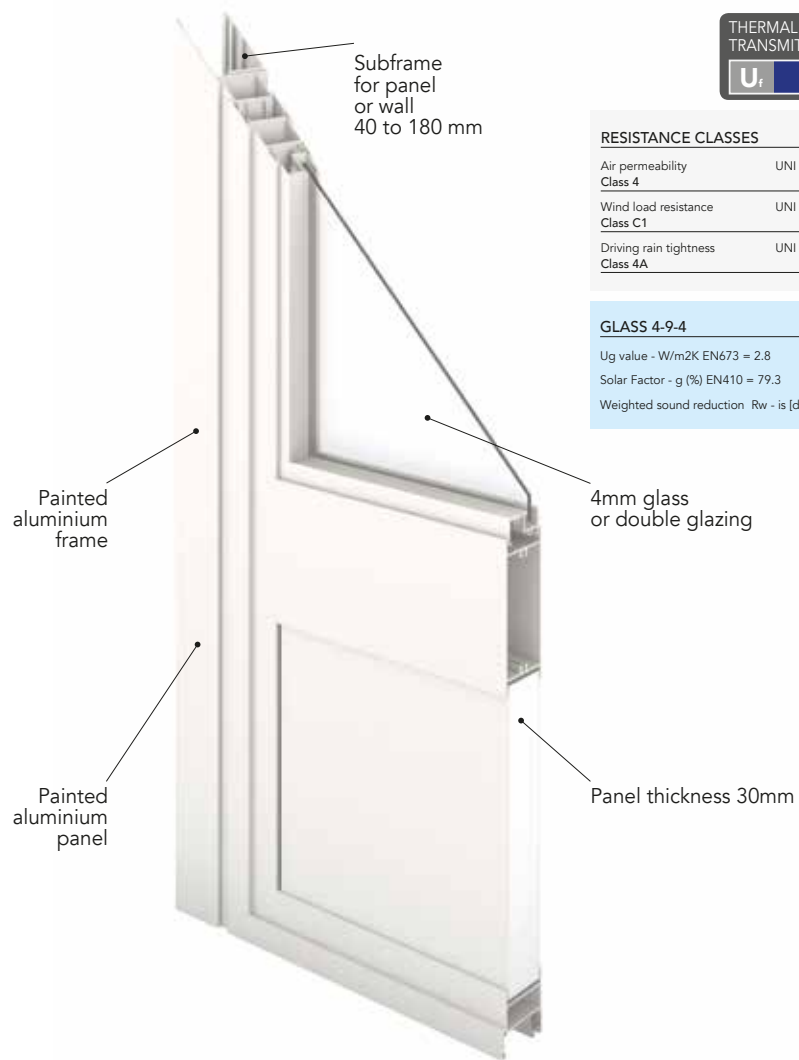

### The 3000 Series

combines the high-quality of an aluminium frame with an affordable price tag. An excellent window-to-floor-area ratio is the main strength of this door.



# WINDOWS

## 3000 SERIES

THERMAL TRANSMITTANCE  $\frac{W}{m^2K}$   
**U<sub>f</sub> 2.98**

### RESISTANCE CLASSES

Air permeability Class 2	UNI EN 1026:2001
Wind load resistance Class C2	UNI EN 12211:2001
Driving rain tightness Class 4A	UNI EN 1027:2001

### GLASS 4-6-4

Ug value - W/m<sup>2</sup>K EN673 = 3.0  
Solar Factor - g (%) EN410 = 79.2  
Weighted sound reduction Rw - is [dB] = NDP

Painted  
aluminium  
frame

Subframe  
for panel  
or wall  
(40 to 180 mm)

4mm glass

## TECHNICAL FEATURES

**Large window**

**Good value for money**

**Rugged and durable  
with reinforced  
profiles**

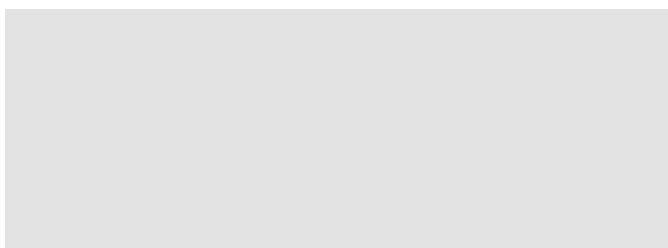

### The 3000 Series

combines the high-quality of an aluminium frame with an affordable price tag. An excellent window-to-floor-area ratio is the main strength of this door.

# 3000 SERIES

## mod. 3000.01

Single door with central crosspiece and protection bars



Applications:

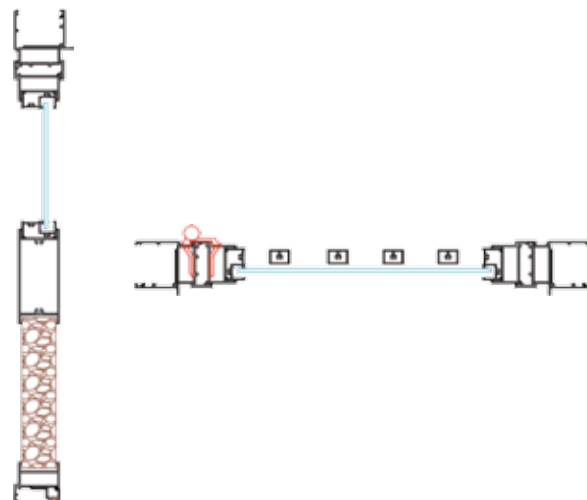

Accessories:



### Description

This type of door has been designed to meet our customers' need to have a product that is suitable for prefabricated buildings for construction sites; it is mainly used as an entrance door and lets plenty of light in.

### Technical details:

- 6060 extruded aluminium alloy profiles (EN 573-3);
- Sealing system with panel and frame seal;
- Frame can be installed on either the inner or the outer side;
- Frame and door are joined with galvanised steel brackets;
- Glass thickness can range from 4 to 6mm;
- Protection bars can be installed on request;
- Profile surfaces are oxidised or powder coated- both treatments are QUALANOD/QUALICOAT certified;
- Door lock with central crosspiece 70mm
- Black nylon handle (aluminium on request);
- Can be installed on 30 to 180mm thick walls with extruded aluminium subframe;
- A pre-pressed pre-painted aluminium sheet steel intrados is supplied for wall thicknesses greater than 180mm.

### Certifications:

- Design and production of aluminium doors and windows; third-party processing of aluminium parts (ISO 9001:2008);
- CE marking according to construction products regulation 305/2011/CE.



### Single door with reversible metal panel



Applications:

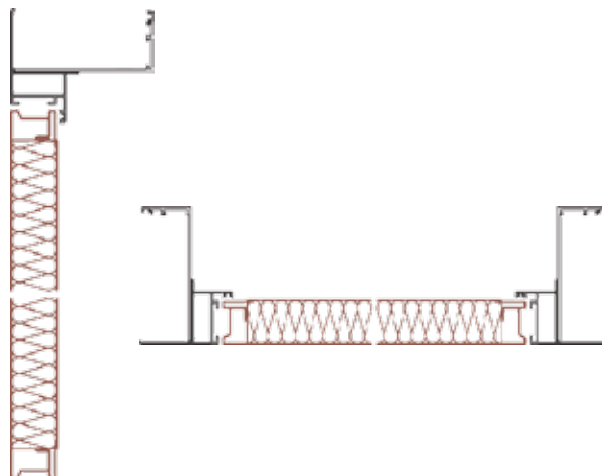

Accessories:



#### Description

This type of door is for interior use and is mainly used on prefabricated construction site sheds.

#### Technical details:

- 6060 extruded aluminium alloy profiles (EN 573-3);
- Reversible;
- Sealing system with frame seal;
- Frame can be installed on either the inner or the outer side;
- Frame and panel are joined with galvanised steel brackets;
- Profile surfaces are oxidised or powder coated - both treatments are QUALANOD/QUALICOAT certified;
- Door lock with central crosspiece (70mm)
- Black nylon handle (aluminium on request);
- Can be installed on 30 to 180mm thick walls with extruded aluminium subframe;
- A pre-pressed pre-painted aluminium sheet steel intrados is supplied for wall thicknesses greater than 180mm.

#### Certifications:

- Design and production of aluminium doors and windows; third-party processing of aluminium parts (ISO 9001:2008);
- CE marking according to construction products regulation 305/2011/CE.



Applications:

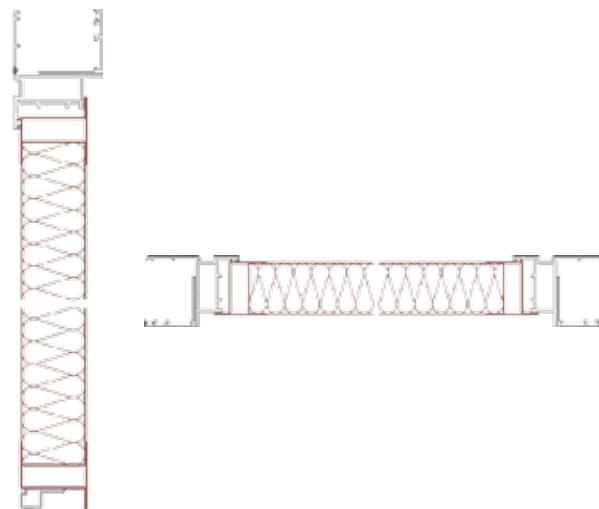

Accessories:



### Description

This type of door is for both interior and/or exterior use and is mainly used on prefabricated construction site sheds.

### Technical details:

- 6060 extruded aluminium alloy profiles (EN 573-3);
- Sealing system with panel and frame seal;
- Frame can be installed on either the inner or the outer side;
- Frame and panel are joined with galvanised steel brackets;
- Glass thickness can range from 4 to 6mm;
- Protection bars can be installed on request;
- Profile surfaces are oxidised or powder coated - both treatments are QUALANOD/QUALICOAT certified;
- Door lock with central crosspiece (70mm)
- Black nylon handle (aluminium on request);
- Can be installed on 30 to 180mm thick walls with extruded aluminium subframe;
- A pre-pressed pre-painted aluminium sheet steel intrados is supplied for wall thicknesses greater than 180mm.

### Certifications:

- Design and production of aluminium doors and windows; third-party processing of aluminium parts (ISO 9001:2008);
- CE marking according to construction products regulation 305/2011/CE.

# 3000 SERIES

## mod. 3000.04

Window with one fixed sash and one sliding sash



Applications:

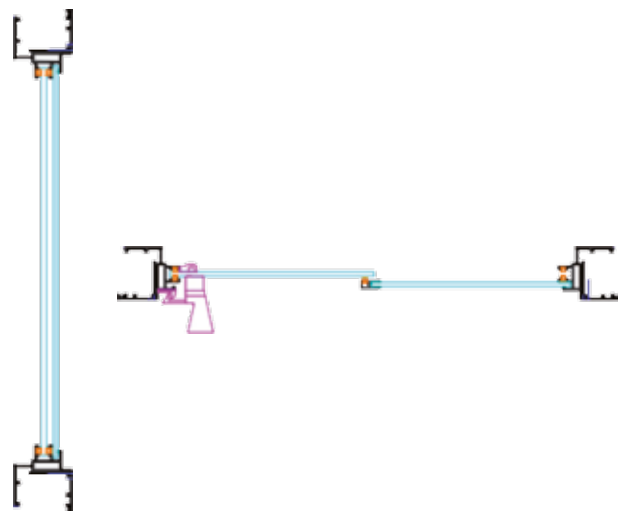

### Description

This type of window is designed for a variety of applications in small rooms and buildings, such as construction site sheds.

### Technical details:

- 6060 extruded aluminium alloy profiles (EN 573-3);
- Double brush seal on window frame;
- The frame is joined with extruded aluminium crimp corner joints;
- The fixed glass panel is 4mm thick;
- The glass that makes up the sliding sash is 5mm thick and has been tempered to increase its resistance;
- Protection bars and/or a fixed insect screen can be installed on request;
- Profile surfaces are oxidised or powder coated - both treatments are QUALANOD/QUALICOAT certified;
- Nylon pull handle fixed to the glass (as a standard);
- Can be installed on 30 to 180mm thick walls with extruded aluminium subframe;
- A pre-pressed pre-painted aluminium sheet steel intrados is supplied for wall thicknesses greater than 180mm.

### Certifications:

- Design and production of aluminium doors and windows; third-party processing of aluminium parts (ISO 9001:2008);
- CE marking according to construction products regulation 305/2011/CE.





Applications:

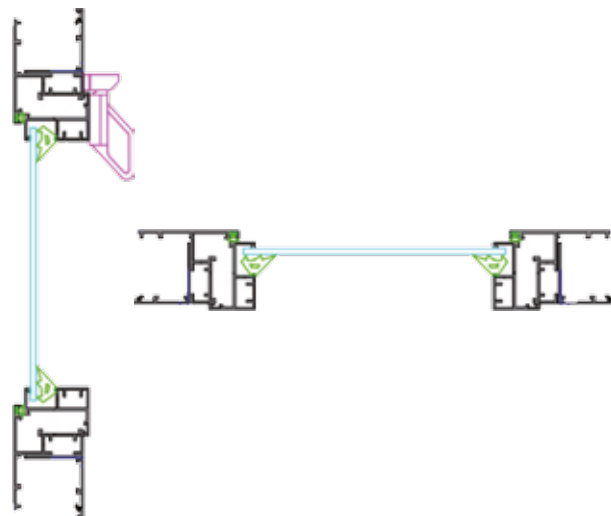

### Description

This type of window is mainly used to ventilated prefabricated toilets and can come in small sizes; it is also suitable for other temporary or permanent constructions.

### Technical details:

- 6060 extruded aluminium alloy profiles (EN 573-3);
- Sealing system with frame seal;
- Frame and panels are joined with extruded aluminium crimp corner joints;
- Glass thickness can range from 4 to 14mm;
- Protection bars and/or a fixed insect screen can be installed on request;
- Profile surfaces are oxidised or powder coated- both treatments are QUALANOD/QUALICOAT certified;
- Closing system with nylon ratchet (as a standard);
- Can be installed on 30 to 180mm thick walls with extruded aluminium subframe;
- A pre-pressed pre-painted aluminium sheet steel intrados is supplied for wall thicknesses greater than 180mm.

### Certifications:

- Design and production of aluminium doors and windows; third-party processing of aluminium parts (ISO 9001:2008);
- CE marking according to construction products regulation 305/2011/CE.



# 3100 SERIES

## DOORS

### TECHNICAL FEATURES

Large window

Good value for money

Non-insulated profile

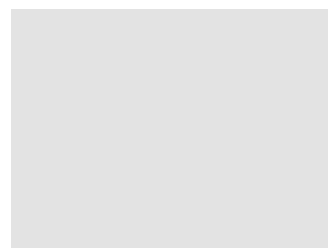
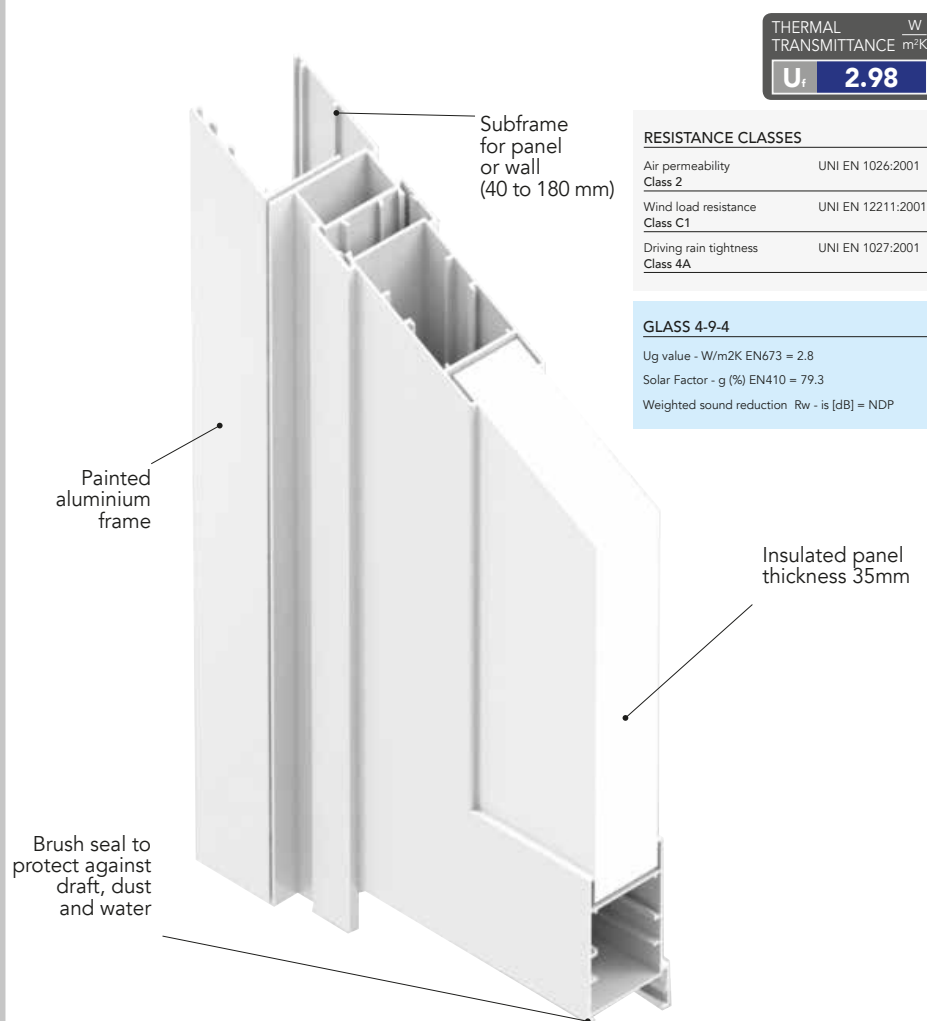

### The 3100 Series

combines the high-quality of an aluminium frame with an affordable price tag. An excellent window-to-floor-area ratio is the main strength of this door.



# WINDOWS

## 3100 SERIES

THERMAL TRANSMITTANCE  $\frac{W}{m^2K}$   
**U<sub>f</sub> 2.98**

### RESISTANCE CLASSES

Air permeability Class 1	UNI EN 1026:2001
Wind load resistance Class C2	UNI EN 12211:2001
Driving rain tightness Class 2A	UNI EN 1027:2001

### GLASS 4-9-4

U<sub>g</sub> value - W/m<sup>2</sup>K EN673 = 2.8  
 Solar Factor - g (%) EN410 = 79.3  
 Weighted sound reduction R<sub>w</sub> - is [dB] = NDP

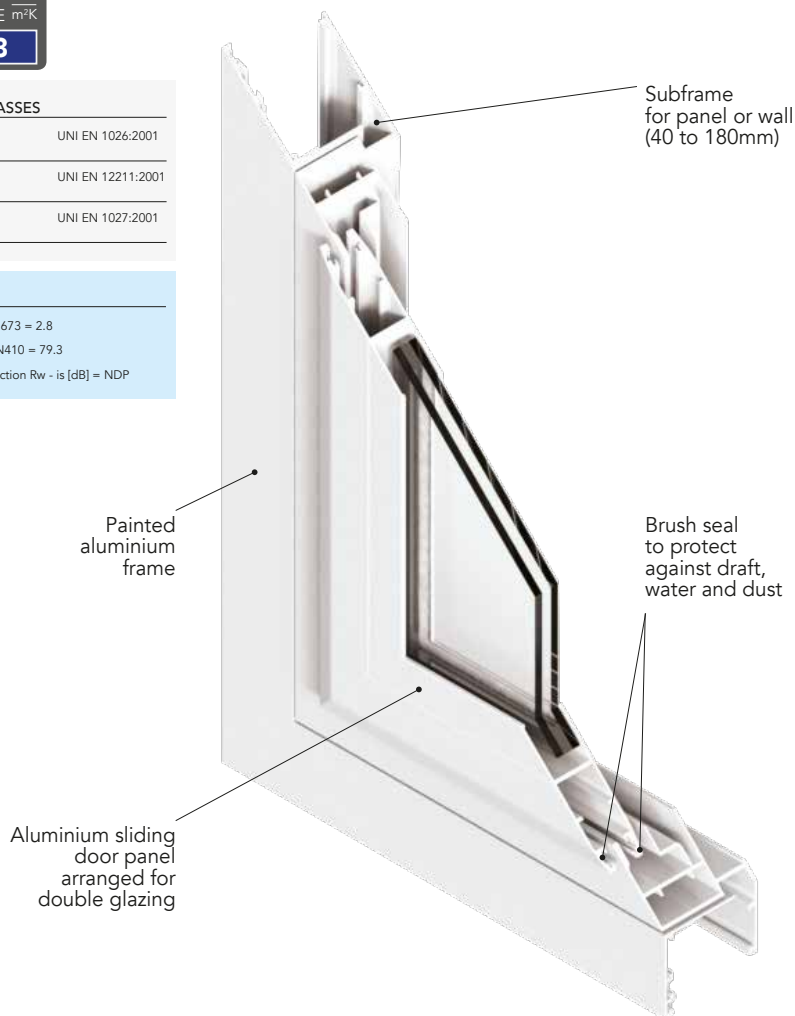

### TECHNICAL FEATURES

**Large window**

**Good value for money**

**Non-insulated profile**



### The 3100 Series

combines the high-quality of an aluminium frame with an affordable price tag. An excellent window-to-floor-area ratio is the main strength of this door.



#### Applications:

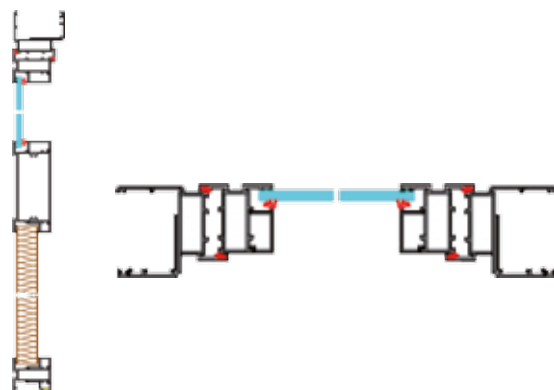

#### Accessories:

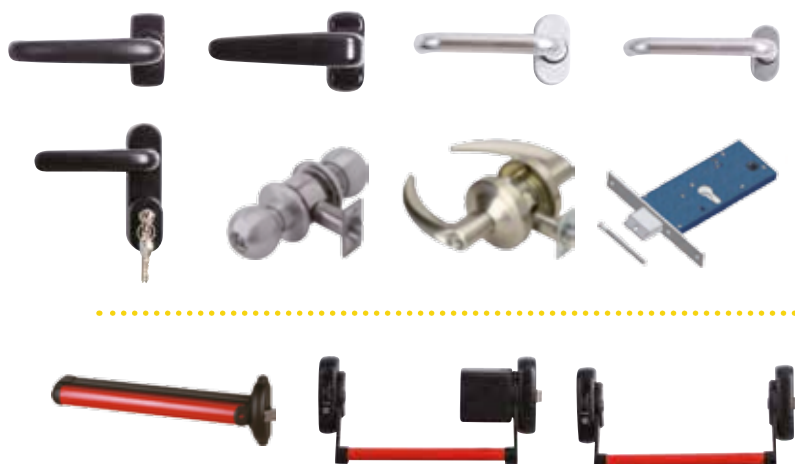

#### Description

This door is suitable for use on prefabricated units. As an exterior door, it lets more light inside the building; it is a good quality product in terms of design and functionality.

#### Technical details:

- 6060 extruded aluminium alloy profiles (EN 573-3);
- Sealing system with panel and frame seal;
- Frame can be installed on either the inner or the outer side;
- Frame and panel are joined with galvanised steel brackets;
- Glass thickness can range from 4 to 21 mm;
- Protection bars can be installed on request;
- Profile surfaces are oxidised or powder coated - both treatments are QUALANOD/QUALICOAT certified;
- Door lock with central crosspiece (70mm)
- Black nylon handle (aluminium on request);
- Can be fitted with: 1 or 3 point locking push bar, hydraulic lock, open/closed indicator;
- Can be installed on 30 to 180 mm thick walls with extruded aluminium subframe;
- A pre-pressed pre-painted aluminium sheet steel intrados is supplied for wall thicknesses greater than 180mm.

#### Certifications:

- Design and production of aluminium doors and windows; third-party processing of aluminium parts (ISO 9001:2008);
- CE marking according to construction products regulation 305/2011/CE.

# 3100 SERIES

## mod. 3100. 02 Double door with central crosspiece



Applications:

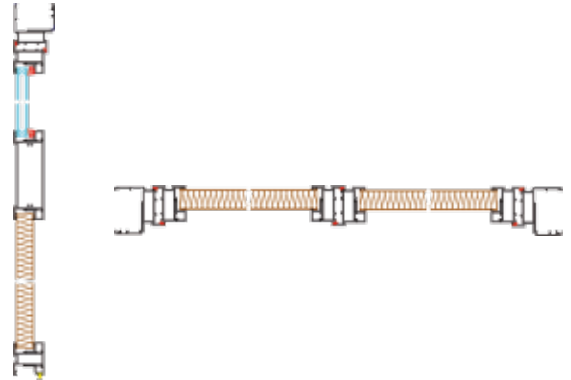

Accessories:

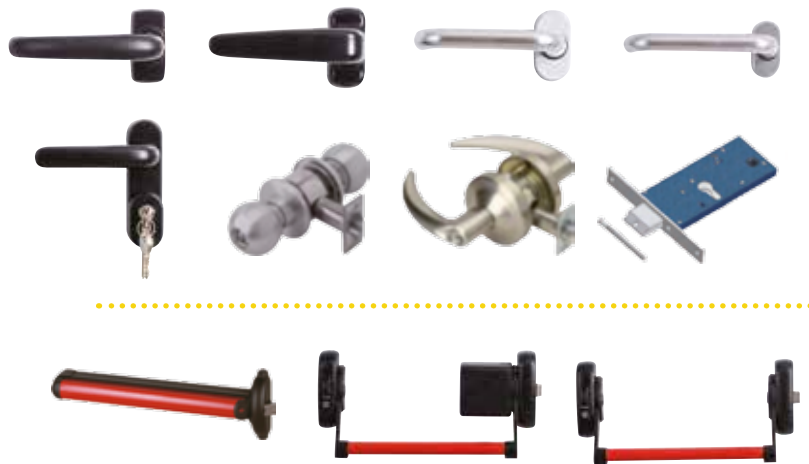

### Description

Our customers love this door because it perfectly combines design and functionality. It can be installed on all prefabricated buildings, in construction sites as well as for other purposes. The double door system is ideal to let more light flow through (half glazed version), or to pass bulky material.

### Technical details:

- 6060 extruded aluminium alloy profiles (EN 573-3);
- Sealing system with panel and frame seal;
- Frame can be installed on either the inner or the outer side;
- Frame and panel are joined with galvanised steel brackets;
- Glass thickness can range from 4 to 21 mm;
- Protection bars can be installed on request;
- Profile surfaces are oxidised or powder coated - both treatments are QUALANOD/QUALICOAT certified;
- Door lock with central crosspiece (70mm)
- Black nylon handle (aluminium on request);
- Can be fitted with: 1 or 3 point locking push bar, hydraulic lock, open/closed indicator;
- Can be installed on 30 to 180 mm thick walls with extruded aluminium subframe;
- A pre-pressed pre-painted aluminium sheet steel intrados is supplied for wall thicknesses greater than 180mm.

### Certifications:

- Design and production of aluminium doors and windows; third-party processing of aluminium parts (ISO 9001:2008);
- CE marking according to construction products regulation 305/2011/CE.



Applications:



Accessories:



### Description

Our customers love this door because it perfectly combines design and functionality. It can be used on all prefabricated buildings, in construction sites as well as for other purposes.

### Technical details:

- 6060 extruded aluminium alloy profiles (EN 573-3);
- Sealing system with panel and frame seal;
- Frame can be installed on either the inner or the outer side;
- The frame is joined with internally-hooked galvanised steel brackets;
- The panel is joined with externally-hooked die-cast aluminium brackets;
- Profile surfaces are oxidised or powder coated- both treatments are QUALANOD/QUALICOAT certified;
- Door lock with upright (35mm)
- Black nylon handle (aluminium on request);
- Can be fitted with: 1 or 3 point locking push bar, 3-point lock, hydraulic lock, open/closed indicator;
- Can be installed on 30 to 180mm thick walls with extruded aluminium subframe;
- A pre-pressed pre-painted aluminium sheet steel intrados is supplied for wall thicknesses greater than 180mm.

### Certifications:

- Design and production of aluminium doors and windows; third-party processing of aluminium parts (ISO 9001:2008);
- CE marking according to construction products regulation 305/2011/CE.



Applications:

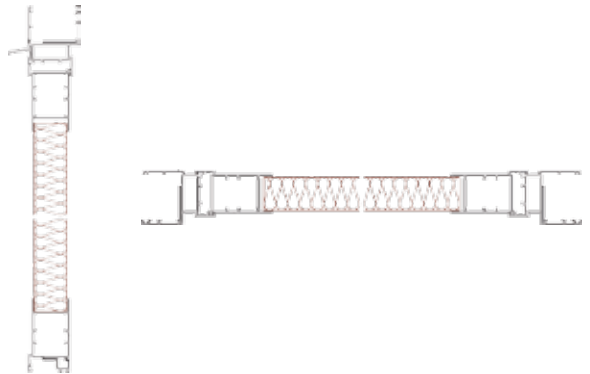

Accessories:



#### Description

This fixture is mainly used as an exterior and/or interior door for prefabricated applications. With its smooth, elegant design, it can be easily used as an interior door.

#### Technical details:

- 6060 extruded aluminium alloy profiles (EN 573-3);
- Sealing system with panel and frame seal;
- Frame can be installed on either the inner or the outer side;
- The frame is joined with internally-hooked galvanised steel brackets;
- The panel is joined with externally-hooked die-cast aluminium brackets;
- Profile surfaces are oxidised or powder coated- both treatments are QUALANOD/QUALICOAT certified;
- Door lock with upright (35mm)
- Black nylon handle (aluminium on request);
- Can be fitted with: 1 or 3 point locking push bar, 3-point lock, hydraulic lock, open/closed indicator;
- Can be installed on 30 to 180 mm thick walls with extruded aluminium subframe;
- A pre-pressed pre-painted aluminium sheet steel intrados is supplied for wall thicknesses greater than 180mm.

#### Certifications:

- Design and production of aluminium doors and windows; third-party processing of aluminium parts (ISO 9001:2008);
- CE marking according to construction products regulation 305/2011/CE.



Applications:

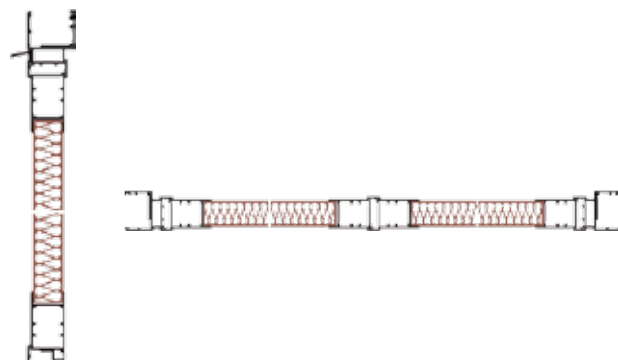

Accessories:

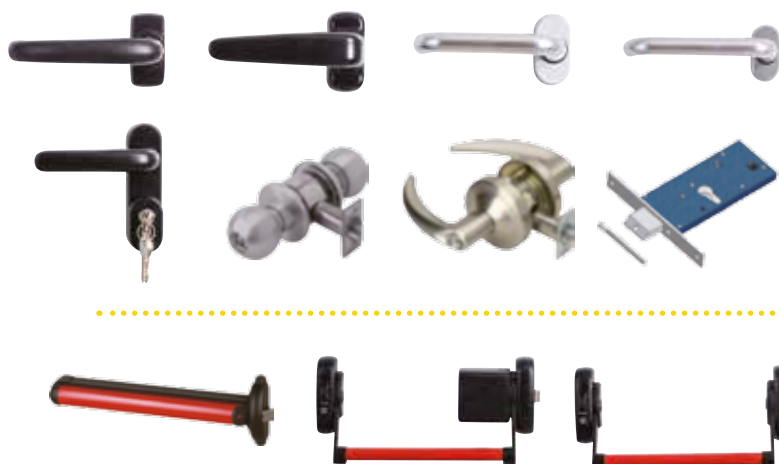

### Description

This door is highly demanded as it combines design and functionality. It can be installed on all prefabricated buildings, in construction sites as well as for other purposes. The double door system is ideal to allow the passage of bulky materials.

### Technical details:

- 6060 extruded aluminium alloy profiles (EN 573-3);
- Sealing system with door and frame seal;
- Frame can be installed on either the inner or the outer side;
- Frame and panel are joined with galvanised steel brackets;
- Profile surfaces are oxidised or powder coated - both treatments are QUALANOD/QUALICOAT certified;
- Door lock with upright (35mm)
- Black nylon handle (aluminium on request);
- Can be fitted with: 1 or 3 point locking push bar, hydraulic lock, open/closed indicator;
- Can be installed on 30 to 180 mm thick walls with extruded aluminium subframe;
- A pre-pressed pre-painted aluminium sheet steel intrados is supplied for wall thicknesses greater than 180mm.

### Certifications:

- Design and production of aluminium doors and windows; third-party processing of aluminium parts (ISO 9001:2008);
- CE marking according to construction products regulation 305/2011/CE.



Applications:

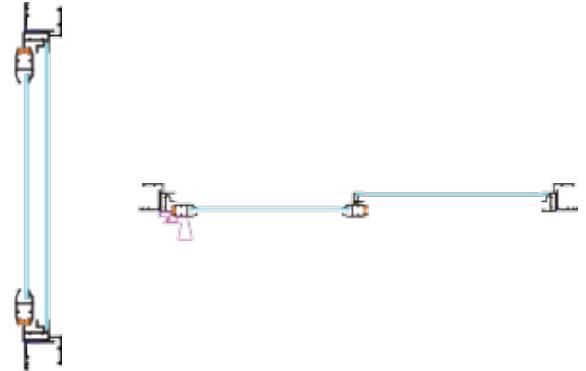

Accessories:



### Description

It adapts to a variety of applications, particularly to small buildings and rooms, as the sliding system does not take up space.

### Technical details:

- 6060 extruded aluminium alloy profiles (EN 573-3);
- Double brush seal on door panel;
- The frame is joined with extruded aluminium crimp corner joints, and the panels with a PVC corner carriage system;
- Glass thickness can range from 4 to 19mm;
- Protection bars and/or a fixed or sliding insect screen can be installed on request;
- Profile surfaces are oxidised or powder coated - both treatments are QUALANOD/QUALICOAT certified;
- Nylon pull handle (standard), aluminium pull handle or recessed aluminium handle on request;
- Can be installed on 30 to 180 mm thick walls with extruded aluminium subframe;
- A pre-pressed pre-painted aluminium sheet steel intrados is supplied for wall thicknesses greater than 180 mm.

### Certifications:

- Design and production of aluminium doors and windows; third-party processing of aluminium parts (ISO 9001:2008);
- CE marking according to construction products regulation 305/2011/CE.



Applications:

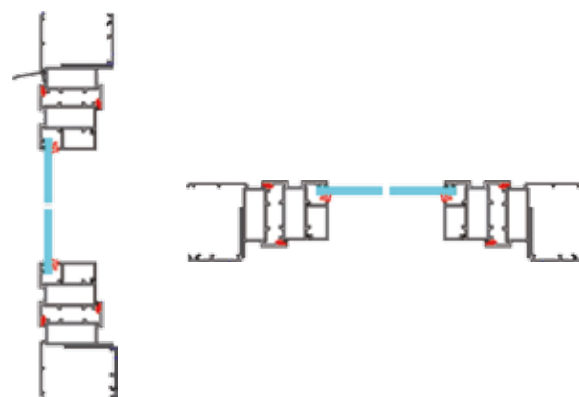

Accessories:



#### Description

It adapts to a variety of applications, particularly to small buildings and rooms, as it does not take up space.

#### Technical details:

- 6060 extruded aluminium alloy profiles (EN 573-3);
- Sealing system with door and frame seal;
- Possibilità di montaggio con telaio in battuta interna o esterna;
- Frame and door are joined with galvanised steel brackets;
- Glass thickness can range from 4 to 21 mm;
- Protection bars and/or an inside roller insect screen can be installed on request;
- Profile surfaces are oxidised or powder coated - both treatments are QUALANOD/QUALICOAT certified;
- Aluminium handle;
- Can be installed on 30 to 180 mm thick walls with extruded aluminium subframe;
- A pre-pressed pre-painted aluminium sheet steel intrados is supplied for wall thicknesses greater than 180 mm.

#### Certifications:

- Design and production of aluminium doors and windows; third-party processing of aluminium parts (ISO 9001:2008);
- CE marking according to construction products regulation 305/2011/CE.



Applications:

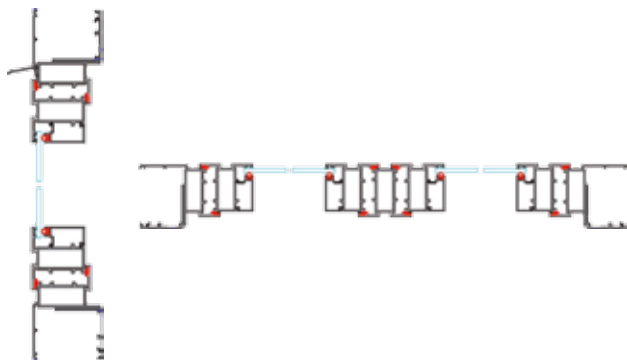

Accessories:



#### Description

This window is used to increase the window-to-floor-area ratio of rooms that require large glass windows. The outward opening system makes it possible to save space in case of small rooms

#### Technical details:

- 6060 extruded aluminium alloy profiles (EN 573-3);
- Sealing system with double door and frame seal;
- Frame can be installed on either the inner or the outer side;
- Frame and panels are joined with galvanised steel brackets;
- The two sections can be opened separately;
- Glass thickness can range from 4 to 21mm;
- Protection bars and/or an inside roller insect screen can be installed on request;
- Profile surfaces are oxidised or powder coated - both treatments are QUALANOD/QUALICOAT certified;
- Can be installed on 30 to 180 mm thick walls with extruded aluminium subframe;
- A pre-pressed pre-painted aluminium sheet steel intrados is supplied for wall thicknesses greater than 180mm.

#### Certifications:

- Design and production of aluminium doors and windows; third-party processing of aluminium parts (ISO 9001:2008);
- CE marking according to construction products regulation 305/2011/CE.



Applications:

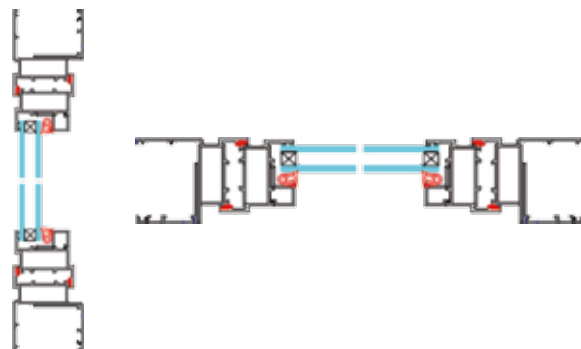

Accessories:



### Description

This window is designed primarily for small-sized prefabricated bathrooms, but it perfectly fits other temporary or permanent buildings. A simple design makes it suitable for renovations or simple applications.

### Technical details:

- 6060 extruded aluminium alloy profiles (EN 573-3);
- Sealing system with door and frame seal;
- Frame can be installed on either the inner or the outer side;
- Frame and panel are joined with galvanised steel brackets;
- Glass thickness can range from 4 to 21 mm;
- Protection bars and/or a fixed insect screen can be installed on request;
- Profile surfaces are oxidised or powder coated - both treatments are QUALANOD/QUALICOAT certified;
- Nylon ratchet (as a standard) - also available in aluminium on request;
- Can be installed on 30 to 180 mm thick walls with extruded aluminium subframe;
- A pre-pressed pre-painted aluminium sheet steel intrados is supplied for wall thicknesses greater than 180 mm.

### Certifications:

- Design and production of aluminium doors and windows; third-party processing of aluminium parts (ISO 9001:2008);
- CE marking according to construction products regulation 305/2011/CE.

# 3100 SERIES

## mod. 3100. 10 Double bottom-hung window



Applications:

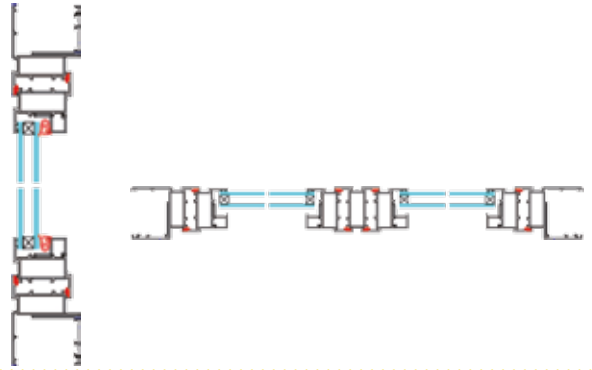

Accessories:



### Description

This window is used to increase the window-to-floor-area ratio in rooms that require large glass windows. It is primarily designed for prefabricated bathrooms, but perfectly fits other temporary or permanent buildings, whether new or existing.

### Technical details:

- 6060 extruded aluminium alloy profiles (EN 573-3);
- Sealing system with door and frame seal;
- Frame can be installed on either the inner or the outer side;
- Frame and panel are joined with galvanised steel brackets;
- Glass thickness can range from 4 to 21 mm;
- Protection bars and/or a fixed insect screen can be installed on request;
- Profile surfaces are oxidised or powder coated - both treatments are QUALANOD/QUALICOAT certified;
- Nylon ratchet (as a standard) - also available in aluminium on request;
- Can be installed on 30 to 180 mm thick walls with extruded aluminium subframe;
- A pre-pressed pre-painted aluminium sheet steel intrados is supplied for wall thicknesses greater than 180 mm.

### Certifications:

- Design and production of aluminium doors and windows; third-party processing of aluminium parts (ISO 9001:2008);
- CE marking according to construction products regulation 305/2011/CE.

# 3200 SERIES

## DOORS

### TECHNICAL FEATURES

Also for residential buildings

Good value for money

Rugged and durable with reinforced profiles

Non-insulated profile

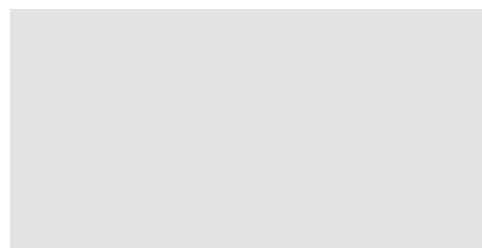
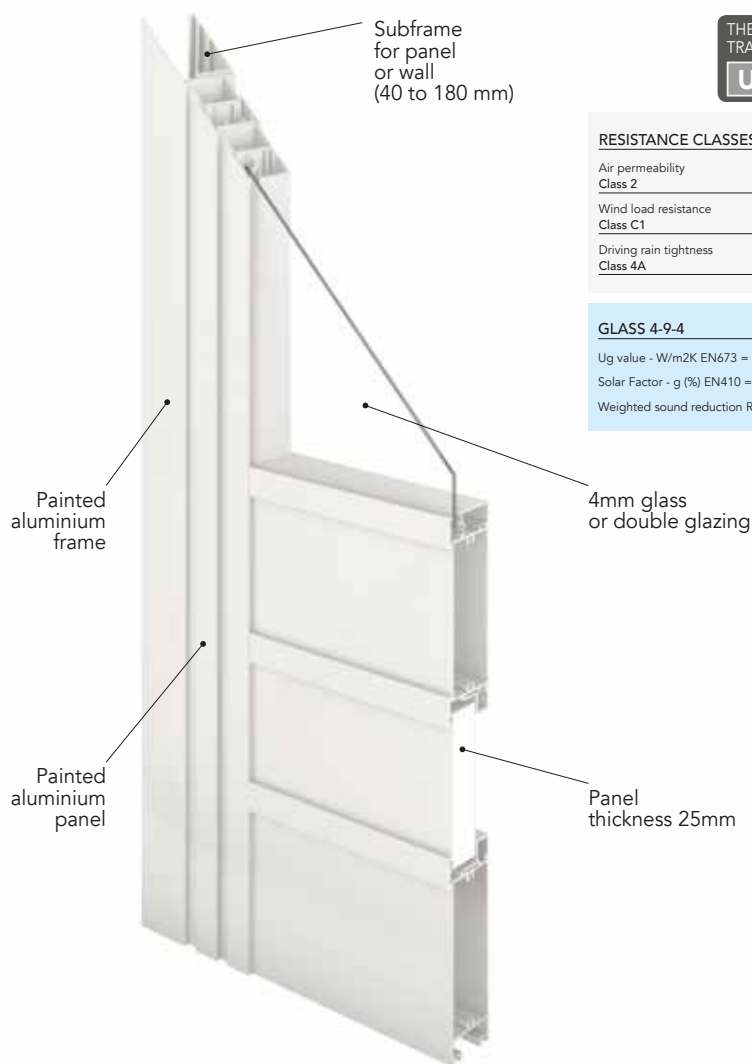

### The 3200 Series

combines the high-quality of an aluminium frame with an affordable price tag. For both industrial and residential buildings.



# WINDOWS

## 3200 SERIES

THERMAL TRANSMITTANCE $\frac{W}{m^2K}$	
<b>U<sub>f</sub></b>	<b>2.98</b>

### RESISTANCE CLASSES

Air permeability Class 2	UNI EN 1026:2001
Wind load resistance Class C1	UNI EN 12211:2001
Driving rain tightness Class 4A	UNI EN 1027:2001

### GLASS 4-9-4

U<sub>g</sub> value - W/m<sup>2</sup>K EN673 = 2.8  
Solar Factor - g (%) EN410 = 79.3  
Weighted sound reduction R<sub>w</sub> - is [dB] = NDP

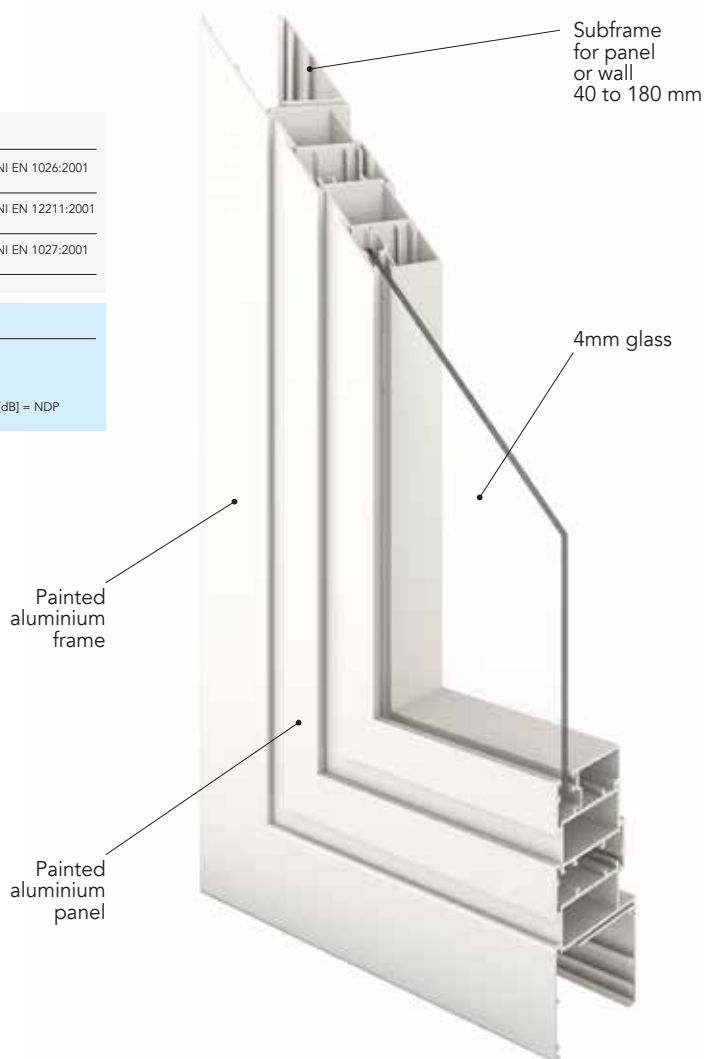

### TECHNICAL FEATURES

**Good value for money**

**Rugged and durable with reinforced profiles**

**Non-insulated profile**

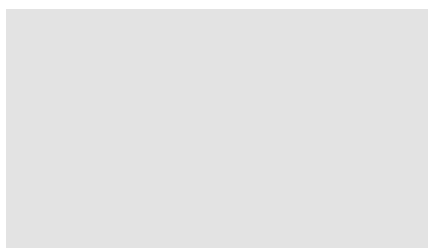

### The 3200 Series

combines the high-quality of an aluminium frame with an affordable price tag.

### Single door with central crosspiece and skirting



Applications:

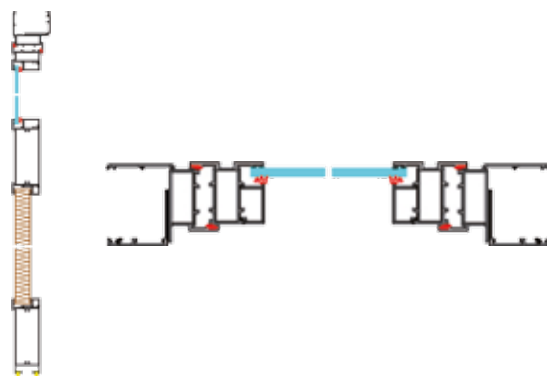

Accessories:

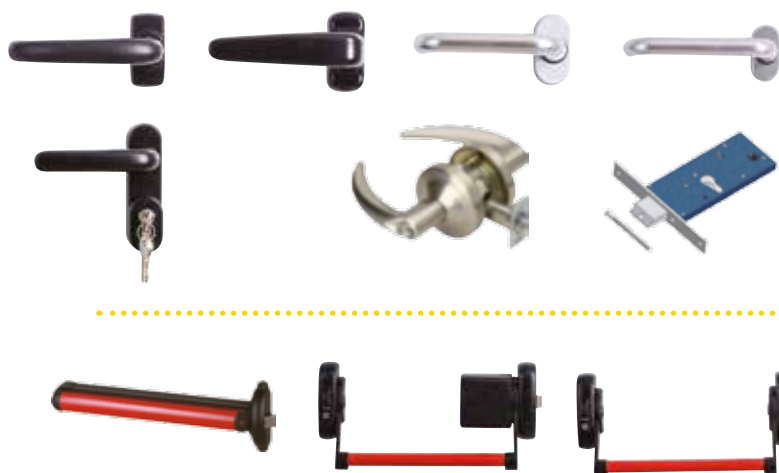

#### Description

Our customers love this door because it perfectly combines design and functionality. It can be installed on all prefabricated buildings, in construction sites as well as for other purposes.

#### Technical details:

- 6060 extruded aluminium alloy profiles (EN 573-3);
- Sealing system with door and frame seal;
- Frame can be installed on either the inner or the outer side;
- Frame and door are joined with galvanised steel brackets;
- Glass thickness can range from 4 to 21 mm;
- Protection bars can be installed on request;
- Profile surfaces are oxidised or powder coated - both treatments are QUALANOD/QUALICOAT certified;
- Door lock with central crosspiece (70mm)
- Black nylon handle (aluminium on request);
- Can be fitted with: 1 or 3 point locking push bar, hydraulic lock, open/closed indicator;
- Can be installed on 30 to 180 mm thick walls with extruded aluminium subframe;
- A pre-pressed pre-painted aluminium sheet steel intrados is supplied for wall thicknesses greater than 180 mm.

#### Certifications:

- Design and production of aluminium doors and windows; third-party processing of aluminium parts (ISO 9001:2008);
- CE marking according to construction products regulation 305/2011/CE.

# 3200 SERIES

## mod. 3200.02

### Double door with central crosspiece and skirting



#### Applications:

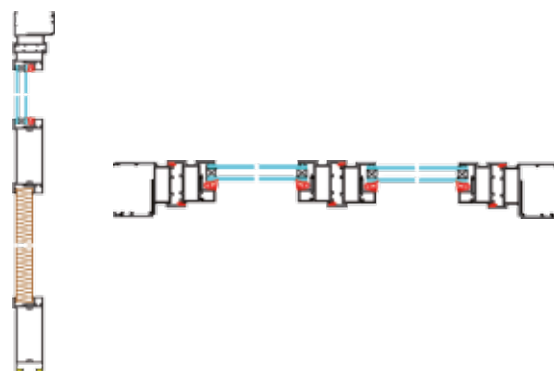

#### Accessories:

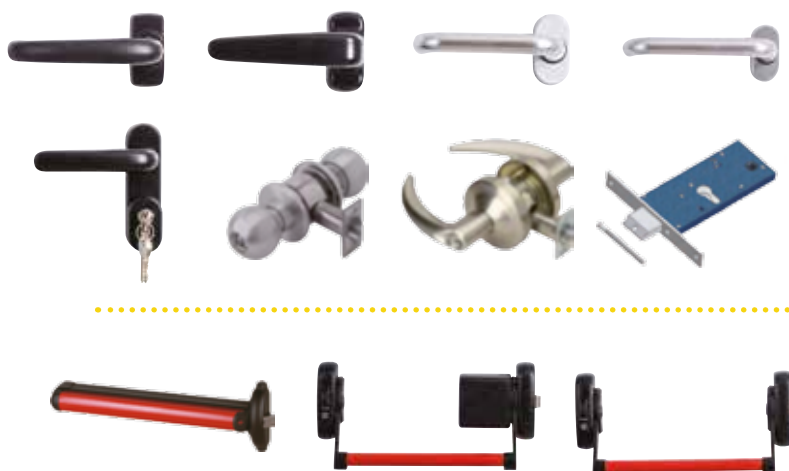

#### Description

Our customers love this door because it perfectly combines design and functionality. It can be installed on all prefabricated buildings, in construction sites as well as for other purposes. The double door system is ideal to let more light flow through (half glazed version).

#### Technical details:

- 6060 extruded aluminium alloy profiles (EN 573-3);
- Sealing system with door and frame seal;
- Frame can be installed on either the inner or the outer side;
- Frame and door are joined with galvanised steel brackets;
- Glass thickness can range from 4 to 21 mm;
- Protection bars can be installed on request;
- Profile surfaces are oxidised or powder coated - both treatments are QUALANOD/QUALICOAT certified;
- Door lock with central crosspiece (70mm)
- Black nylon handle (aluminium on request);
- Can be fitted with: 1 or 3 point locking push bar, hydraulic lock, open/closed indicator;
- Can be installed on 30 to 180 mm thick walls with extruded aluminium subframe;
- A pre-pressed pre-painted aluminium sheet steel intrados is supplied for wall thicknesses greater than 180 mm.

#### Certifications:

- Design and production of aluminium doors and windows; third-party processing of aluminium parts (ISO 9001:2008);
- CE marking according to construction products regulation 305/2011/CE.



Applications:

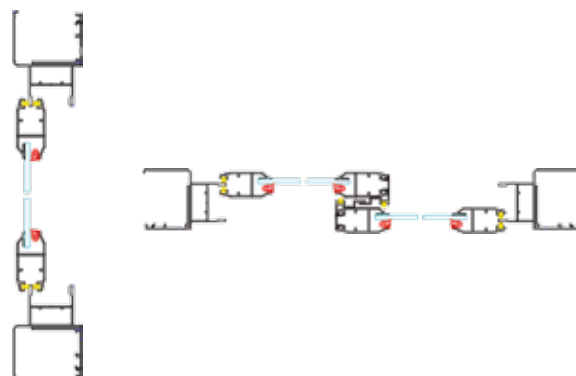

Accessories:



### Description

This window is used to increase the window-to-floor-area ratio in rooms that require large glass windows. It adapts to a variety of applications, particularly to small buildings and rooms, as the sliding system does not take up space.

### Technical details:

- 6060 extruded aluminium alloy profiles (EN 573-3);
- Double brush seal on window panels;
- Frame can be installed on either the inner or the outer side;
- The frame is joined with externally-hooked die-cast aluminium brackets, and the panels with a PVC corner carriage system;
- Glass thickness can range from 4 to 19mm;
- Protection bars and/or a fixed, sliding or roller insect screen can be installed on request;
- Profile surfaces are oxidised or powder coated - both treatments are QUALANOD/QUALICOAT certified;
- Nylon pull handle (standard), aluminium pull handle or recessed aluminium handle on request;
- Can be installed on 30 to 180 mm thick walls with extruded aluminium subframe;
- A pre-pressed pre-painted aluminium sheet steel intrados is supplied for wall thicknesses greater than 180 mm.

### Certifications:

- Design and production of aluminium doors and windows; third-party processing of aluminium parts (ISO 9001:2008);
- CE marking according to construction products regulation 305/2011/CE.



Applications:

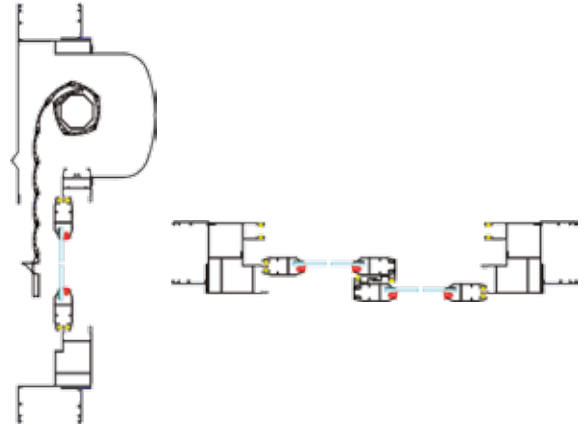

Accessories:



#### Description

This window with roller shutter can make rooms completely dark and is ideal for dormitories, schools, and offices.

It is also particularly suitable for small buildings and rooms, as the sliding system does not take up space.

#### Technical details:

- 6060 extruded aluminium alloy profiles (EN 573-3);
- Double brush seal on window panels;
- The frame is joined with externally-hooked die-cast aluminium brackets, and the panels with a PVC corner carriage system;
- Glass thickness can range from 4 to 19 mm;
- Protection bars and/or a fixed or roller insect screen can be installed on request;
- Profile surfaces are oxidised or powder coated - both treatments are QUALANOD/QUALICOAT certified;
- Nylon pull handle (standard), aluminium pull handle or recessed aluminium handle on request;
- Roller shutter with 8x37 PVC profile (aluminium roller shutters can be installed on request)
- Can be installed on 30 to 180 mm thick walls with extruded aluminium subframe;
- A pre-pressed pre-painted aluminium sheet steel intrados is supplied for wall thicknesses greater than 180 mm.

#### Certifications:

- Design and production of aluminium doors and windows; third-party processing of aluminium parts (ISO 9001:2008);
- CE marking according to construction products regulation 305/2011/CE.



Applications:

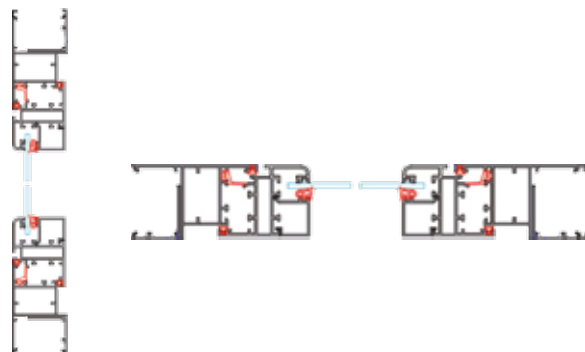

Accessories:



### Description

"Tilt-and-turn" is the most versatile opening system in any application, as it creates two opening positions - a swing window and a bottom-hung window.

### Technical details:

- 6060 extruded aluminium alloy profiles (EN 573-3);
- Sealing system with panel and frame bulb attachment;
- Frame can be installed on either the inner or the outer side;
- Frame and panel are joined with externally-hooked die cast aluminium brackets;
- Glass thickness can range from 4 to 24 mm;
- Protection bars and/or a fixed or roller insect screen can be installed on request;
- Profile surfaces are oxidised or powder coated - both treatments are QUALANOD/QUALICOAT certified;
- Aluminium handle;
- Can be installed on 30 to 180 mm thick walls with extruded aluminium subframe;
- A pre-pressed pre-painted aluminium sheet steel intrados is supplied for wall thicknesses greater than 180 mm.

### Certifications:

- Design and production of aluminium doors and windows; third-party processing of aluminium parts (ISO 9001:2008);
- CE marking according to construction products regulation 305/2011/CE.



Applications:

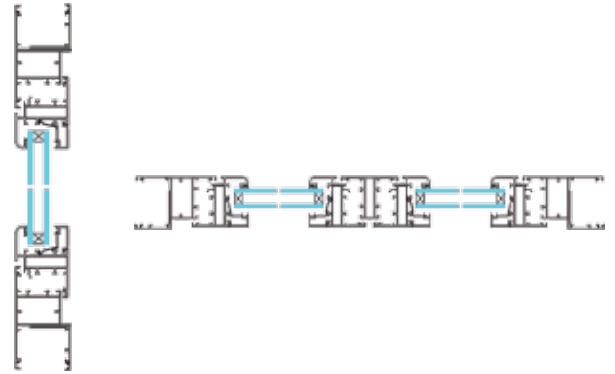

#### Description

"Tilt-and-turn" is the most versatile opening system in any application, as it creates two opening positions - a swing window and a bottom-hung window. This window is used to increase the window-to-floor-area ratio in rooms that require large glass windows.

#### Technical details:

- 6060 extruded aluminium alloy profiles (EN 573-3);
- Sealing system with panel and frame bulb attachment;
- Frame installed on the outer side;
- Frame and panel are joined with externally-hooked die cast aluminium brackets;
- Glass thickness can range from 4 to 24 mm;
- Protection bars and/or a fixed or roller insect screen, or an inside blackout curtain can be added on request;
- Profile surfaces are oxidised or powder coated - both treatments are QUALANOD/QUALICOAT certified;
- Aluminium handle;
- Can be installed on 30 to 200 mm thick walls with extruded aluminium subframe;
- A pre-pressed pre-painted aluminium sheet steel intrados is supplied for wall thicknesses greater than 200 mm.

#### Certifications:

- Design and production of aluminium doors and windows; third-party processing of aluminium parts (ISO 9001:2008);
- CE marking according to construction products regulation 305/2011/CE.

Double window with one fixed panel and one tilt-and-turn panel



Applications:

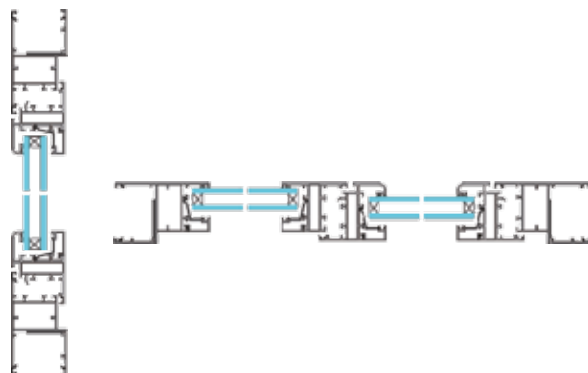

### Description

This window is used to increase the window-to-floor-area ratio in rooms that require large glass windows. "Tilt-and-turn" is the most versatile opening system in any application, as it creates two opening positions - a swing window and a bottom-hung window.

### Technical details:

- 6060 extruded aluminium alloy profiles (EN 573-3);
- Sealing system with panel and frame bulb attachment;
- Frame installed on the outer side;
- Frame and panels are joined with externally-hooked die-cast aluminium brackets;
- Glass thickness can range from 4 to 24 mm;
- Protection bars and/or a fixed or roller insect screen can be installed on request;
- Profile surfaces are oxidised or powder coated - both treatments are QUALANOD/QUALICOAT certified;
- Aluminium handle;
- Can be installed on 30 to 200 mm thick walls with extruded aluminium subframe;
- A pre-pressed pre-painted aluminium sheet steel intrados is supplied for wall thicknesses greater than 200 mm.

### Certifications:

- Design and production of aluminium doors and windows; third-party processing of aluminium parts (ISO 9001:2008);
- CE marking according to construction products regulation 305/2011/CE.

# 3200 SERIES

## mod. 3200.08

### Tilt-and-turn window with roller shutters



Applications:

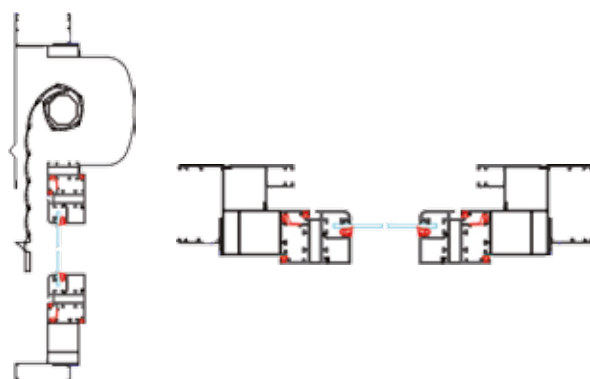

Accessories:



#### Description

The roller shutter can be used to darken rooms completely, which makes this product ideal for dormitories, schools and offices. "Tilt-and-turn" is the most versatile opening system in any application, as it creates two opening positions - a swing window and a bottom-hung window.

#### Technical details:

- 6060 extruded aluminium alloy profiles (EN 573-3);
- Sealing system with panel and frame bulb attachment;
- Frame installed on the outer side;
- Frame and panels are joined with externally-hooked die-cast aluminium brackets;
- Glass thickness can range from 4 to 24 mm;
- Protection bars and/or a fixed or roller insect screen can be installed on request;
- Profile surfaces are oxidised or powder coated - both treatments are QUALANOD/QUALICOAT certified;
- Aluminium handle;
- Roller shutter with 8x37 PVC profile (aluminium roller shutters can be installed on request)
- Can be installed on 30 to 200 mm thick walls with extruded aluminium subframe;
- A pre-pressed pre-painted aluminium sheet steel intrados is supplied for wall thicknesses greater than 200 mm.

#### Certifications:

- Design and production of aluminium doors and windows; third-party processing of aluminium parts (ISO 9001:2008);
- CE marking according to construction products regulation 305/2011/CE.

## mod. 3200.09

### Tilt-and-turn double window with roller shutter



Applications:

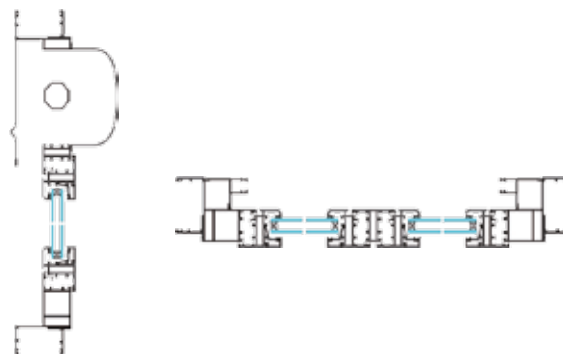

#### Description

This window is used to increase the window-to-floor-area ratio in rooms that require large glass windows. "Tilt-and-turn" is the most versatile opening system in any application, as it creates two opening positions - a swing window and a bottom-hung window.

#### Technical details:

- 6060 extruded aluminium alloy profiles (EN 573-3);
- Sealing system with panel and frame bulb attachment;
- Frame installed on the outer side;
- Frame and panels are joined with externally-hooked die-cast aluminium brackets;
- Glass thickness can range from 4 to 24 mm;
- Protection bars and/or a fixed or roller insect screen can be installed on request;
- Profile surfaces are oxidised or powder coated - both treatments are QUALANOD/QUALICOAT certified;
- Aluminium handle;
- Can be installed on 30 to 200 mm thick walls with extruded aluminium subframe;
- A pre-pressed pre-painted aluminium sheet steel intrados is supplied for wall thicknesses greater than 200 mm.

#### Certifications:

- Design and production of aluminium doors and windows; third-party processing of aluminium parts (ISO 9001:2008);
- CE marking according to construction products regulation 305/2011/CE.

# 3200 SERIES

## mod. 3200. 10

Double window with one fixed panel and one tilt-and-turn panel, with roller shutter



Applications:

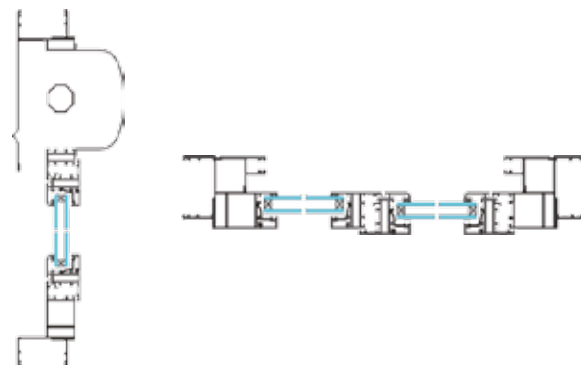

### Description

This window is used to increase the window-to-floor-area ratio in rooms that require large glass windows. "Tilt-and-turn" is the most versatile opening system in any application, as it creates two opening positions - a swing window and a bottom-hung window.

### Technical details:

- 6060 extruded aluminium alloy profiles (EN 573-3);
- Sealing system with panel and frame bulb attachment;
- Frame installed on the outer side;
- Frame and panels are joined with externally-hooked die-cast aluminium brackets;
- Glass thickness can range from 4 to 24mm;
- Protection bars and/or a fixed or roller insect screen can be installed on request;
- Profile surfaces are oxidised or powder coated - both treatments are QUALANOD/QUALICOAT certified;
- Aluminium handle;
- Can be installed on 30 to 200mm thick walls with extruded aluminium subframe;
- A pre-pressed pre-painted aluminium sheet steel intrados is supplied for wall thicknesses greater than 200mm.

### Certifications:

- Design and production of aluminium doors and windows; third-party processing of aluminium parts (ISO 9001:2008);
- CE marking according to construction products regulation 305/2011/CE.



Applications:

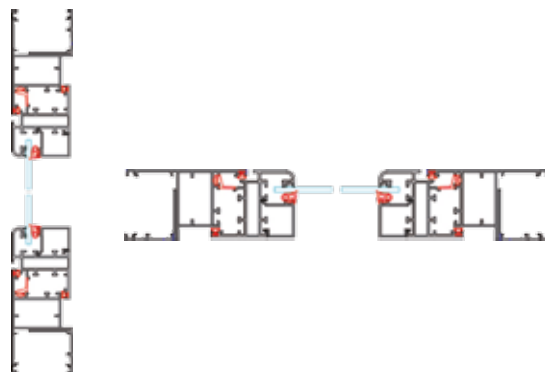

Accessories:



### Description

A casement window is the most traditional, simple and versatile window.

It perfectly adapts to any application, with either inward or outward opening.

### Technical details:

- 6060 extruded aluminium alloy profiles (EN 573-3);
- Sealing system with double panel and frame seal;
- Frame can be installed on either the inner or the outer side;
- Frame and panels are joined with galvanised steel brackets;
- Glass thickness can range from 4 to 24mm;
- Protection bars and/or a fixed or roller insect screen can be installed on request;
- Profile surfaces are oxidised or powder coated - both treatments are QUALANOD/QUALICOAT certified;
- Can be installed on 30 to 180mm thick walls with extruded aluminium subframe;
- A pre-pressed pre-painted aluminium sheet steel intrados is supplied for wall thicknesses greater than 180mm.

### Certifications:

- Design and production of aluminium doors and windows; third-party processing of aluminium parts (ISO 9001:2008);
- CE marking according to construction products regulation 305/2011/CE.



Applications:

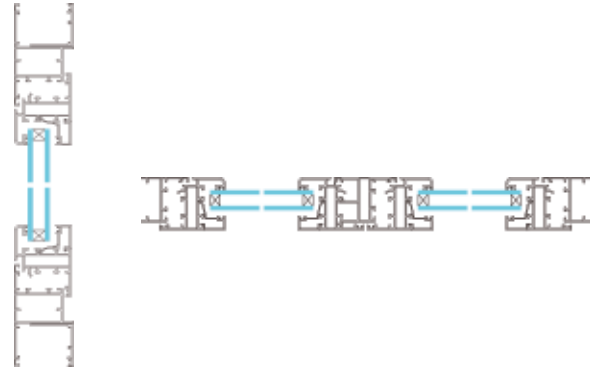

Accessories:



### Description

This window is used to increase the window-to-floor-area ratio in rooms that require large glass windows. A casement window is the most traditional, simple and versatile window. It perfectly adapts to any application, with either inward or outward opening.

### Technical details:

- 6060 extruded aluminium alloy profiles (EN 573-3);
- Sealing system with double panel and frame seal;
- Frame can be installed on either the inner or the outer side;
- Frame and panels are joined with galvanised steel brackets;
- Glass thickness can range from 4 to 24mm;
- Protection bars and/or a fixed or roller insect screen can be installed on request;
- Profile surfaces are oxidised or powder coated - both treatments are QUALANOD/QUALICOAT certified;
- Can be installed on 30 to 200mm thick walls with extruded aluminium subframe;
- A pre-pressed pre-painted aluminium sheet steel intrados is supplied for wall thicknesses greater than 200mm.

### Certifications:

- Design and production of aluminium doors and windows; third-party processing of aluminium parts (ISO 9001:2008);
- CE marking according to construction products regulation 305/2011/CE.



Applications:

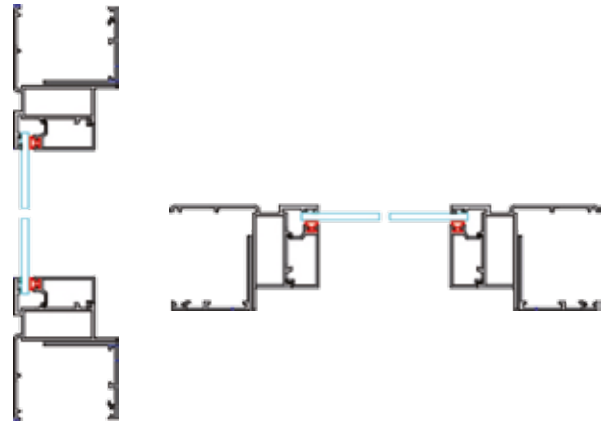

#### Description

This window has been designed to make rooms brighter.

#### Technical details:

- 6060 extruded aluminium alloy profiles (EN 573-3);
- Frame can be installed on either the inner or the outer side;
- The frame is joined with internally-hooked galvanised steel brackets;
- Glass thickness can range from 4 to 21 mm;
- Protection bars can be installed on request;
- Profile surfaces are oxidised or powder coated - both treatments are QUALANOD/QUALICOAT certified;
- Can be installed on 30 to 180mm thick walls with extruded aluminium subframe;
- A pre-pressed pre-painted aluminium sheet steel intrados is supplied for wall thicknesses greater than 180mm.

#### Certifications:

- Design and production of aluminium doors and windows; third-party processing of aluminium parts (ISO 9001:2008);
- CE marking according to construction products regulation 305/2011/CE.

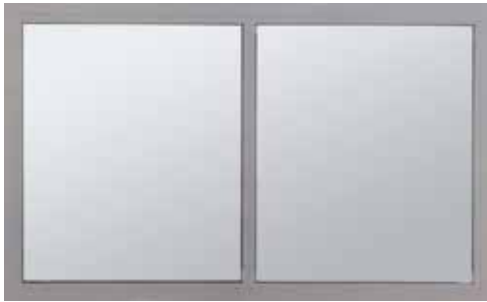

Applications:

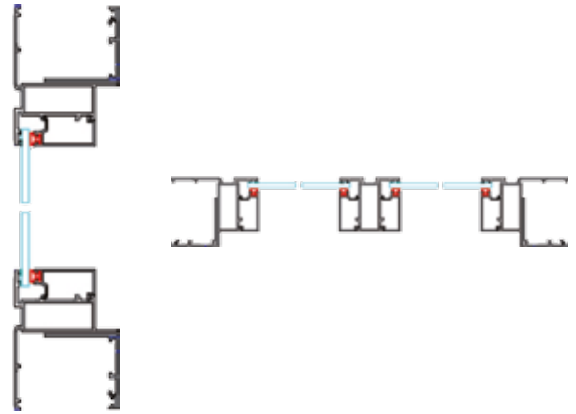

#### Description

The double fixed window is used to increase the window-to-floor-area ratio in rooms that require large glass windows.

This window has been designed to make rooms brighter.

#### Technical details:

- 6060 extruded aluminium alloy profiles (EN 573-3);
- Frame can be installed on either the inner or the outer side;
- The frame is joined with internally-hooked galvanised steel brackets;
- Glass thickness can range from 4 to 21mm;
- Protection bars can be installed on request;
- Profile surfaces are oxidised or powder coated - both treatments are QUALANOD/QUALICOAT certified;
- Can be installed on 30 to 180mm thick walls with extruded aluminium subframe;
- A pre-pressed pre-painted aluminium sheet steel intrados is supplied for wall thicknesses greater than 180mm.

#### Certifications:

- Design and production of aluminium doors and windows; third-party processing of aluminium parts (ISO 9001:2008);
- CE marking according to construction products regulation 305/2011/CE.



Applications:

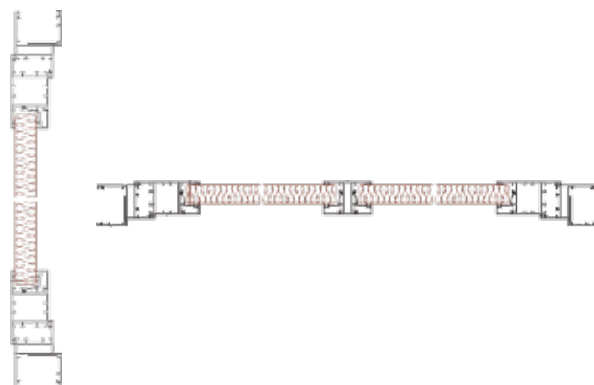

#### Description

This gas-strut door is ideal for distribution facilities such as cafés, newsstands, etc.

Rugged and durable, it also ensures high security when closed.

#### Technical details:

- 6060 extruded aluminium alloy profiles (EN 573-3);
- Sealing system with double panel and frame seal;
- Frame can be installed on either the inner or the outer side;
- Frame and panels are joined with externally-hooked die-cast aluminium brackets;
- Opens with suitably sized gas struts;
- The panel is made of polystyrene with 5/10 pre-painted galvanised sheet metal and is 25mm thick (35mm on request);
- Aluminium handle;
- Profile surfaces are oxidised or powder coated - both treatments are QUALANOD/QUALICOAT certified;
- Can be installed on 30 to 180mm thick walls with extruded aluminium subframe;
- A pre-pressed pre-painted aluminium sheet steel intrados is supplied for wall thicknesses greater than 180mm.

#### Certifications:

- Design and production of aluminium doors and windows; third-party processing of aluminium parts (ISO 9001:2008);
- CE marking according to construction products regulation 305/2011/CE.

# 3200 SERIES

## mod. 3200. 16

### Air conditioner window



Applications:

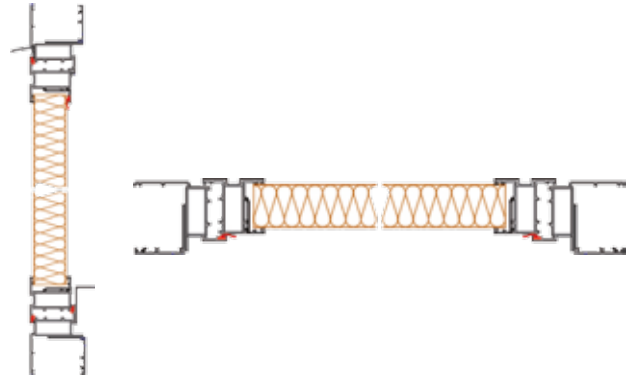

#### Description

This window has been designed for buildings with monoblock air conditioners. The sash that opens outwards supports the weight of the air conditioner, thereby avoiding the use of brackets. The sash can be closed whenever necessary, and ensures excellent weather resistance.

#### Technical details:

- 6060 extruded aluminium alloy profiles (EN 573-3);
- Standard waterproof seal on the panel and reinforced seal on the frame;
- Frame can be installed on either the inner or the outer side;
- Frame and panels are joined with internally-hooked galvanised steel brackets;
- 35mm polystyrene panel with 5/10 pre-painted galvanised sheet metal;
- Profile surfaces are oxidised or powder coated- both treatments are QUALANOD/QUALICOAT certified;
- Closing system with nylon ratchet;
- Opening system with galvanised steel arms;
- Can be installed on 30 to 180mm thick walls with extruded aluminium subframe;
- A pre-pressed pre-painted aluminium sheet steel intrados is supplied for wall thicknesses greater than 180mm.

#### Certifications:

- Design and production of aluminium doors and windows; third-party processing of aluminium parts (ISO 9001:2008);
- CE marking according to construction products regulation 305/2011/CE.



Applications:

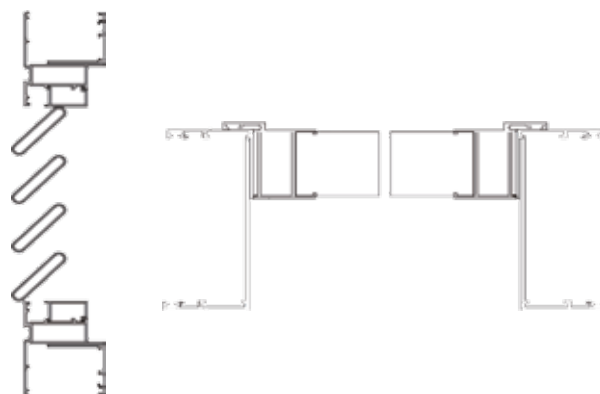

### Description

The fixed louver grill is mainly used in rooms that require continuous ventilation (Technical rooms, Toilets, etc.). Can be installed on all wall types and on new and existing doors and windows.

### Technical details:

- 6060 extruded aluminium alloy profiles (EN 573-3);
- Frame can be installed on either the inner or the outer side;
- The frame is joined with internally-hooked galvanised steel brackets;
- Louvres are arranged at a 45° inclination;
- A fixed insect screen can be installed on request;
- Profile surfaces are oxidised or powder coated - both treatments are QUALANOD/QUALICOAT certified;
- Can be installed on 30 to 180mm thick walls with extruded aluminium subframe;
- A pre-pressed pre-painted aluminium sheet steel intrados is supplied for wall thicknesses greater than 180mm.

### Certifications:

- Design and production of aluminium doors and windows; third-party processing of aluminium parts (ISO 9001:2008);
- CE marking according to construction products regulation 305/2011/CE.



# 3300 SERIES

## DOORS

### TECHNICAL FEATURES

**R40 profile**

**Rugged and durable with reinforced profiles**

**Non-insulated profile**



THERMAL TRANSMITTANCE  $\frac{W}{m^2K}$   
**U<sub>f</sub> 2.98**

#### RESISTANCE CLASSES

Air permeability Class 3 UNI EN 1026:2001

Wind load resistance Class C1 UNI EN 12211:2001

Driving rain tightness Class 7A UNI EN 1027:2001

#### GLASS 4-9-4

Ug value - W/m<sup>2</sup>K EN673 = 2.8

Solar Factor - g (%) EN410 = 79.3

Weighted sound reduction Rw - is [dB] = NDP

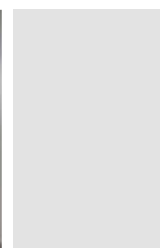

### The 3300 Series

combines the high-quality of an aluminium frame with an affordable price tag. An excellent window-to-floor-area ratio is the main strength of this door.



# WINDOWS

## 3300 SERIES

THERMAL TRANSMITTANCE $\frac{W}{m^2K}$	
<b>U<sub>f</sub></b>	<b>2.98</b>

### RESISTANCE CLASSES

Air permeability Class 3	UNI EN 1026:2001
Wind load resistance Class C1	UNI EN 12211:2001
Driving rain tightness Class 7A	UNI EN 1027:2001

### GLASS 4-9-4

U<sub>g</sub> value - W/m<sup>2</sup>K EN673 = 2.8  
 Solar Factor - g (%) EN410 = 79.3  
 Weighted sound reduction R<sub>w</sub> - is [dB] = NDP

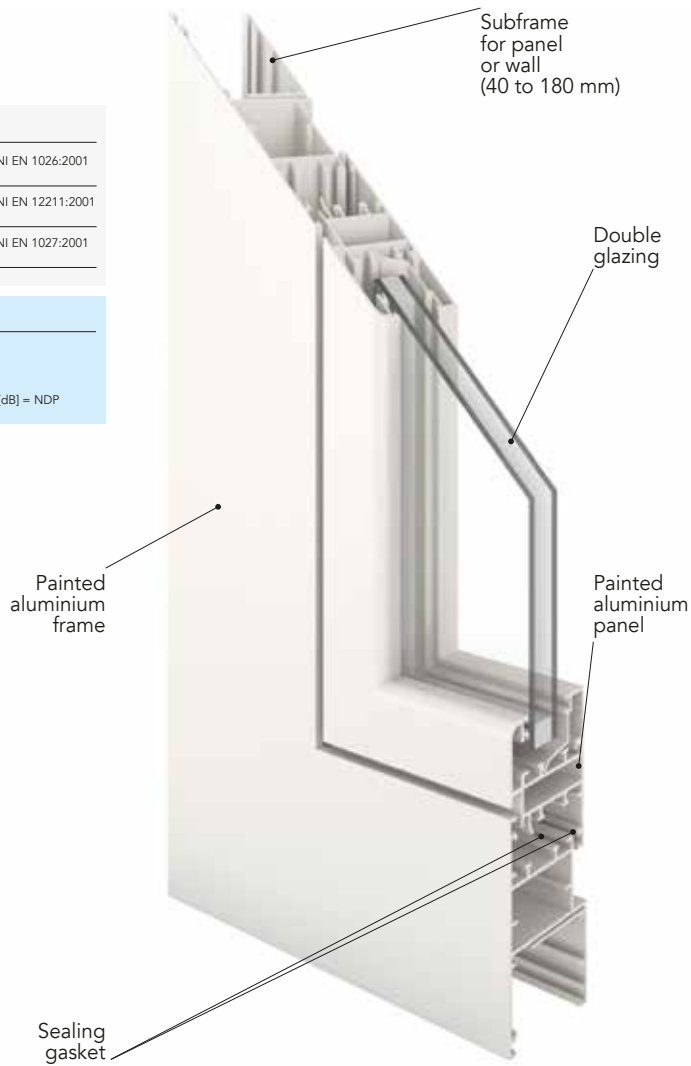

### TECHNICAL FEATURES

#### R40 profile

**Rugged and durable with reinforced profiles**

**Non-insulated profile**



### The 3300 Series

combines the high-quality of an aluminium frame with an affordable price tag. An excellent window-to-floor-area ratio is the main strength of this door.

# 3300 SERIES

## mod. 3300.01

### R40 interior door with rounded jamb



#### Applications:

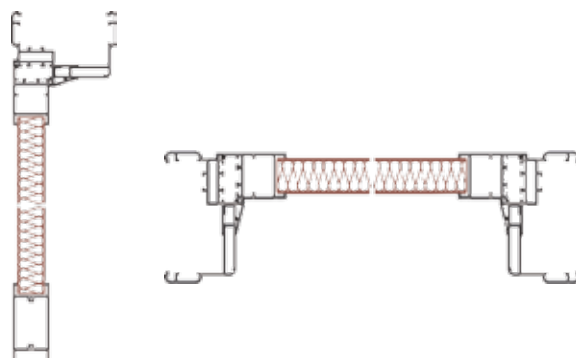

#### Accessories:

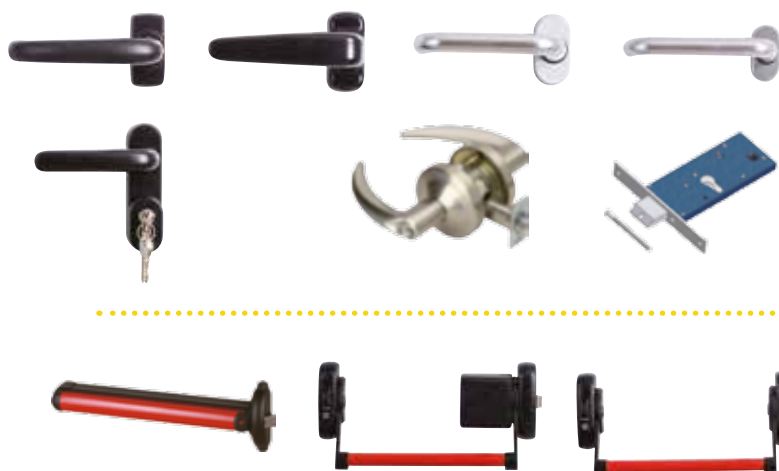

#### Description

Our customers love this door because it perfectly combines design and functionality. Suitable for residential and industrial buildings such as gyms, changing rooms and hospitals.

#### Technical details:

- 6060 extruded aluminium alloy profiles (EN 573-3);
- Sealing system with panel and frame seal;
- Frame can be installed on either the inner or the outer side;
- The frame is joined with internally-hooked galvanised steel brackets;
- The panel is joined with externally-hooked die-cast aluminium brackets;
- Profile surfaces are oxidised or powder coated - both treatments are QUALANOD/QUALICOAT certified;
- Door lock with upright (35mm)
- Black nylon handle (aluminium on request);
- Can be fitted with: 1 or 3 point locking push bar, 3-point lock, hydraulic lock, open/closed indicator;
- Can be installed on 80 to 300mm thick walls with extruded aluminium subframe;

#### Certifications:

- Design and production of aluminium doors and windows; third-party processing of aluminium parts (ISO 9001:2008);
- CE marking according to construction products regulation 305/2011/CE.





### Applications:

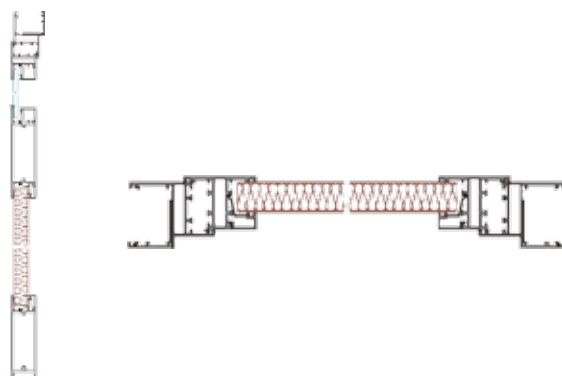

### Accessories:

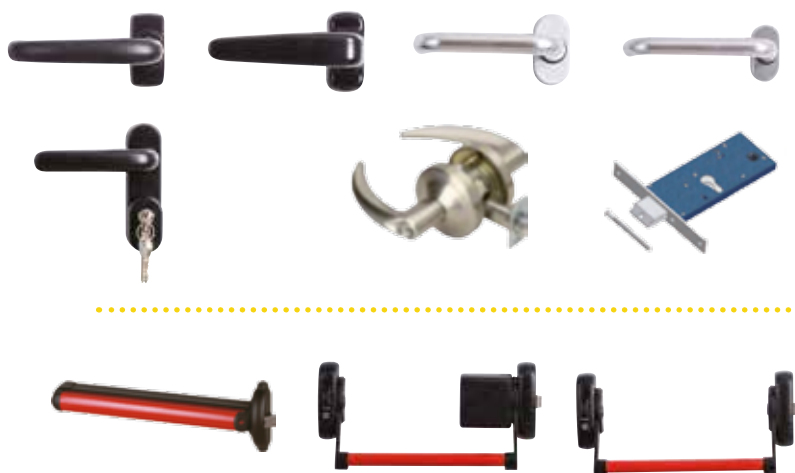

### Description

This door is suitable for use on prefabricated units. As an exterior door, it lets more light inside the building; it is a good quality product in terms of design and functionality.

### Technical details:

- 6060 extruded aluminium alloy profiles (EN 573-3);
- Sealing system with panel and frame seal;
- Frame can be installed on either the inner or the outer side;
- Frame and door are joined with galvanised steel brackets;
- Glass thickness can range from 4 to 24mm;
- Protection bars can be installed on request;
- Profile surfaces are oxidised or powder coated- both treatments are QUALANOD/QUALICOAT certified;
- Door lock with central crosspiece (70mm)
- Black nylon handle (aluminium on request);
- Can be fitted with: 1 or 3 point locking push bar, hydraulic lock, open/closed indicator;
- Can be installed on 30 to 180mm thick walls with extruded aluminium subframe;
- A pre-pressed pre-painted aluminium sheet steel intrados is supplied for wall thicknesses greater than 180mm.

### Certifications:

- Design and production of aluminium doors and windows; third-party processing of aluminium parts (ISO 9001:2008);
- CE marking according to construction products regulation 305/2011/CE.



Applications:

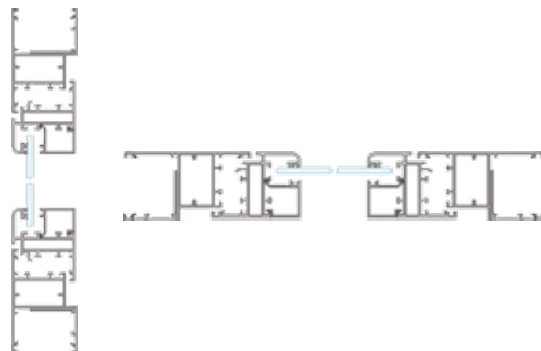

### Description

This window is designed primarily for small-sized prefabricated bathrooms, but it perfectly fits other temporary or permanent buildings. A simple design makes it suitable for renovations or simple applications.

### Technical details:

- 6060 extruded aluminium alloy profiles (EN 573-3);
- Sealing system with panel and frame seal;
- Frame can be installed on either the inner or the outer side;
- Frame and door are joined with galvanised steel brackets;
- Glass thickness can range from 4 to 28mm;
- Protection bars and/or a fixed insect screen can be installed on request;
- Profile surfaces are oxidised or powder coated - both treatments are QUALANOD/QUALICOAT certified;
- Nylon ratchet (as a standard) - also available in aluminium on request;
- Can be installed on 30 to 180mm thick walls with extruded aluminium subframe;
- A pre-pressed pre-painted aluminium sheet steel intrados is supplied for wall thicknesses greater than 180mm.

### Certifications:

- Design and production of aluminium doors and windows; third-party processing of aluminium parts (ISO 9001:2008);
- CE marking according to construction products regulation 305/2011/CE.



Applications:

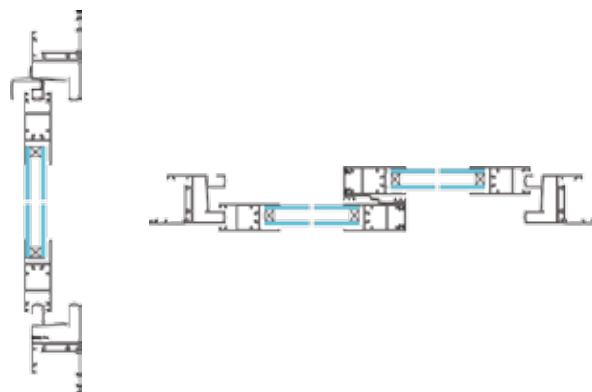

### Description

This window is used to increase the window-to-floor-area ratio in rooms that require large glass windows. It adapts to a variety of applications, particularly to small buildings and rooms, as the sliding system does not take up space.

### Technical details:

- 6060 extruded aluminium alloy profiles (EN 573-3);
- Double brush seal on window panels;
- Frame can be installed on either the inner or the outer side;
- The frame is joined with externally-hooked die-cast aluminium brackets, and the panels with a PVC corner carriage system;
- Glass thickness can range from 4 to 20mm;
- Protection bars and/or a fixed, sliding or roller insect screen can be installed on request;
- Profile surfaces are oxidised or powder coated - both treatments are QUALANOD/QUALICOAT certified;
- Nylon pull handle (standard), aluminium pull handle or recessed aluminium handle on request;
- Can be installed on 30 to 180mm thick walls with extruded aluminium subframe;
- A pre-pressed pre-painted aluminium sheet steel intrados is supplied for wall thicknesses greater than 180mm.

### Certifications:

- Design and production of aluminium doors and windows; third-party processing of aluminium parts (ISO 9001:2008);
- CE marking according to construction products regulation 305/2011/CE.

# 4000 SERIES

## DOORS

### TECHNICAL FEATURES

Large window

Good value for money

Rugged and durable with reinforced profiles

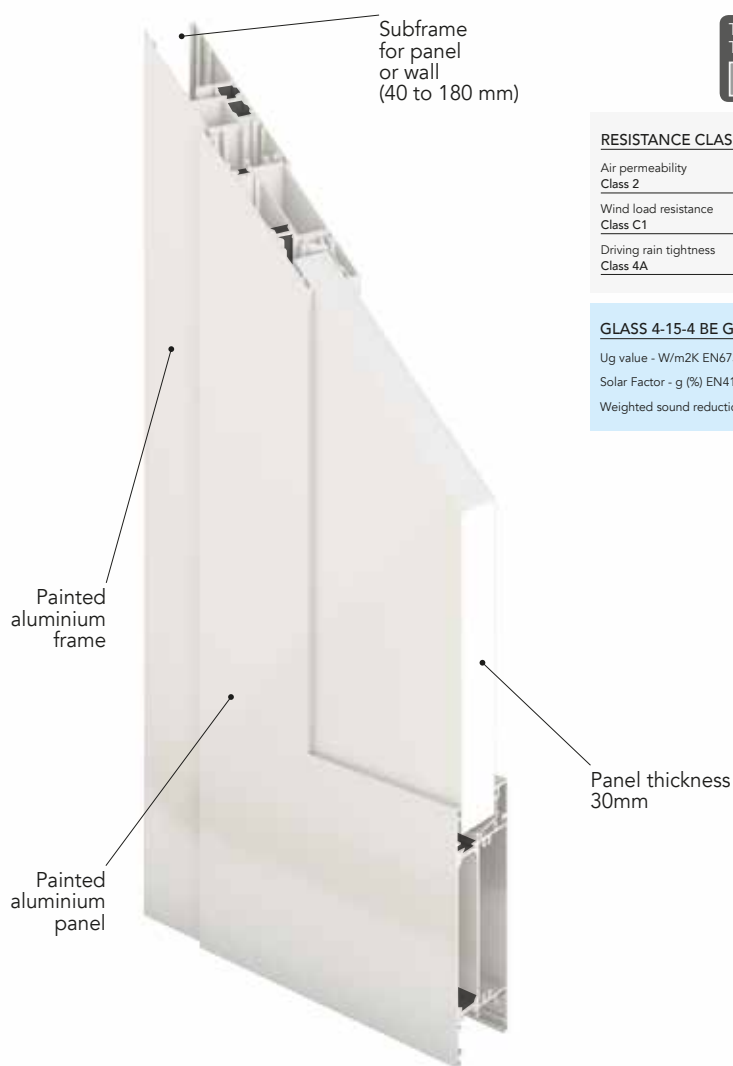

THERMAL TRANSMITTANCE $\frac{W}{m^2K}$
<b>U<sub>f</sub> 1.70</b>

#### RESISTANCE CLASSES

Air permeability Class 2	UNI EN 1026:2001
Wind load resistance Class C1	UNI EN 12211:2001
Driving rain tightness Class 4A	UNI EN 1027:2001

#### GLASS 4-15-4 BE GAS

Ug value - W/m <sup>2</sup> K EN673 = 1.0
Solar Factor - g (%) EN410 = 52.8
Weighted sound reduction Rw - is [dB] = NDP

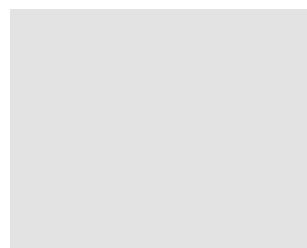

### The 4000 Series

combines the high-quality of an aluminium frame with an affordable price tag. An excellent window-to-floor-area ratio is the main strength of this door.



# WINDOWS

## 4000 SERIES

THERMAL TRANSMITTANCE $\frac{W}{m^2K}$	
<b>U<sub>f</sub></b>	<b>1.80</b>

### RESISTANCE CLASSES

Air permeability Class 2	UNI EN 1026:2001
Wind load resistance Class C1	UNI EN 12211:2001
Driving rain tightness Class 4A	UNI EN 1027:2001

### GLASS 4-15-4 BE GAS

U <sub>g</sub> value - W/m <sup>2</sup> K EN673 = 1.0
Solar Factor - g (%) EN410 = 52.8
Weighted sound reduction R <sub>w</sub> - is [dB] = NDP

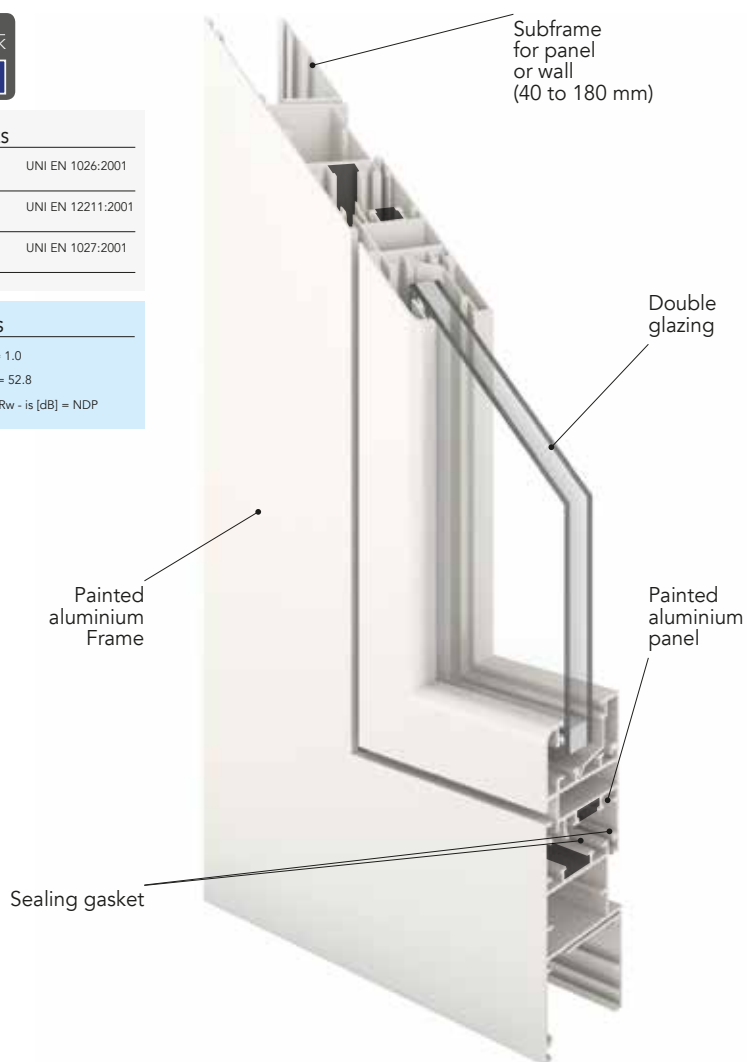

### TECHNICAL FEATURES

Large window

Good value for money

Rugged and durable with reinforced profiles



### The 4000 Series

combines the high-quality of an aluminium frame with an affordable price tag. An excellent window-to-floor-area ratio is the main strength of this door.



Applications:

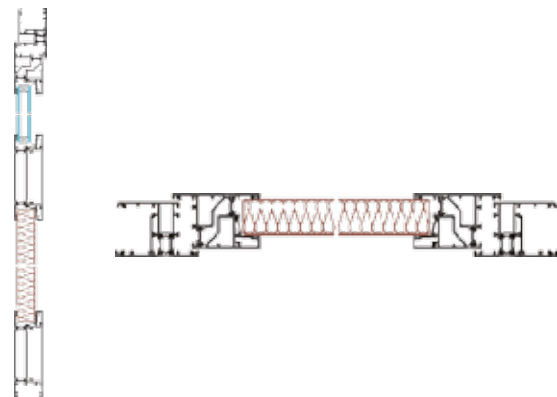

Accessories:

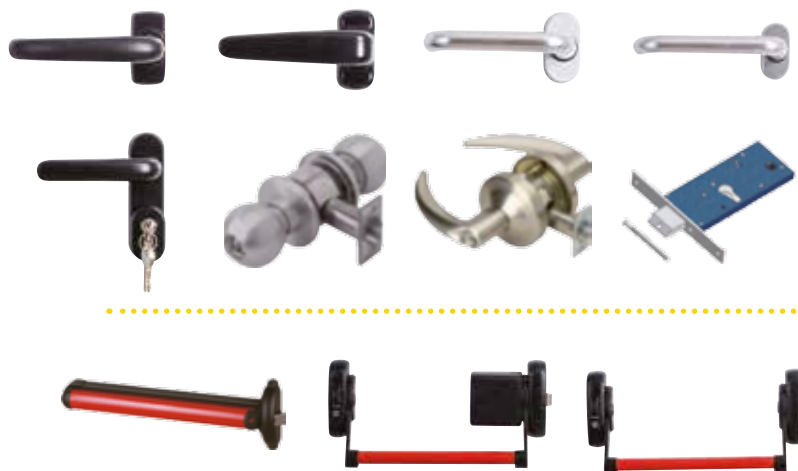

### Description

This door is suitable for use on prefabricated units. As an exterior door, it lets more light inside the building; it is a good quality product in terms of design and functionality.

This type of door is used and recommended where high-performance insulation is required.

### Technical details:

- 6060 extruded aluminium alloy profiles (EN 573-3);
- Sealing system with panel and frame seal;
- Frame can be installed on either the inner or the outer side;
- Frame and panel are joined with galvanised steel brackets;
- Glass thickness can range from 4 to 30mm;
- Protection bars can be installed on request;
- Profile surfaces are oxidised or powder coated - both treatments are QUALANOD/QUALICOAT certified;
- Door lock with upright (35mm)
- Black nylon handle (aluminium on request);
- Can be fitted with: 1 or 3 point locking push bar, hydraulic lock, open/closed indicator;
- Can be installed on 30 to 180mm thick walls with extruded aluminium subframe;
- A pre-pressed pre-painted aluminium sheet steel intrados is supplied for wall thicknesses greater than 180mm.

### Certifications:

- Design and production of aluminium doors and windows; third-party processing of aluminium parts (ISO 9001:2008);
- CE marking according to construction products regulation 305/2011/CE.



Applications:

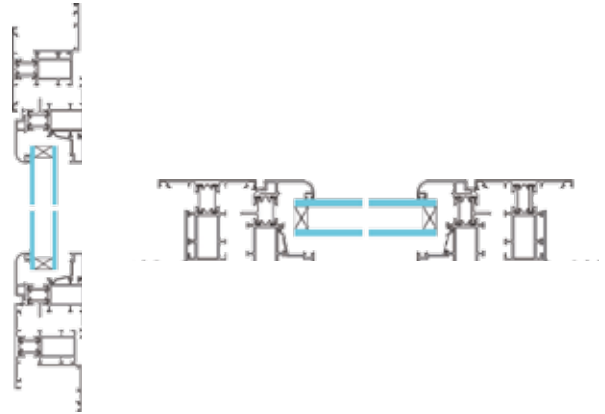

#### Description

This window is designed primarily for small-sized prefabricated bathrooms, but it perfectly fits other temporary or permanent buildings. A simple design makes it suitable for renovations or simple applications. This window is especially recommended where high-performance insulation is required.

#### Technical details:

- 6060 extruded aluminium alloy profiles (EN 573-3);
- Sealing system with panel and frame seal;
- Frame can be installed on either the inner or the outer side;
- Frame and panel are joined with galvanised steel brackets;
- Glass thickness can range from 4 to 30mm;
- Protection bars and/or a fixed insect screen can be installed on request;
- Profile surfaces are oxidised or powder coated - both treatments are QUALANOD/QUALICOAT certified;
- Closing system with nylon ratchet (as a standard) - also available in aluminium on request;
- Can be installed on 30 to 180mm thick walls with extruded aluminium subframe;
- A pre-pressed pre-painted aluminium sheet steel intrados is supplied for wall thicknesses greater than 180mm.

#### Certifications:

- Design and production of aluminium doors and windows; third-party processing of aluminium parts (ISO 9001:2008);
- CE marking according to construction products regulation 305/2011/CE.



Applications:

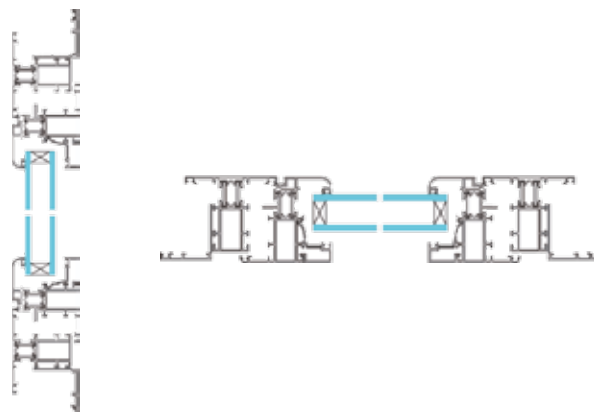

#### Description

“Tilt-and-turn” is the most versatile opening system in any application, as it creates two opening positions - a swing window and a bottom-hung window. This window is especially recommended where high-performance insulation is required.

#### Technical details:

- 6060 extruded aluminium alloy profiles (EN 573-3);
- Sealing system with panel and frame bulb attachment;
- Frame installed on the outer side;
- Frame and panels are joined with externally-hooked die-cast aluminium brackets;
- Glass thickness can range from 4 to 30mm;
- Protection bars and/or a fixed or roller insect screen can be installed on request;
- Profile surfaces are oxidised or powder coated - both treatments are QUALANOD/QUALICOAT certified;
- Aluminium handle;
- Can be installed on 30 to 200mm thick walls with extruded aluminium subframe;
- A pre-pressed pre-painted aluminium sheet steel intrados is supplied for wall thicknesses greater than 200mm.

#### Certifications:

- Design and production of aluminium doors and windows; third-party processing of aluminium parts (ISO 9001:2008);
- CE marking according to construction products regulation 305/2011/CE.



# 5000 SERIES

## TECHNICAL FEATURES

Large window

Good value for money

Rugged and durable with reinforced profiles

## DOORS

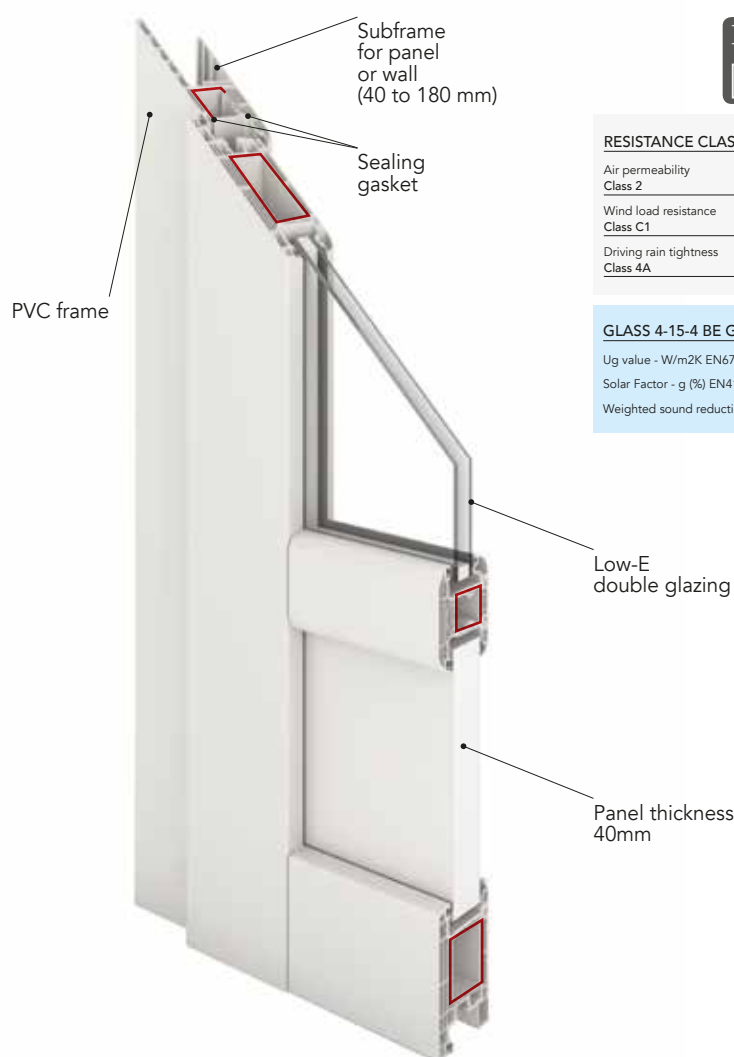

THERMAL TRANSMITTANCE  $\frac{W}{m^2K}$   
**U<sub>f</sub> 1.60**

### RESISTANCE CLASSES

Air permeability Class 2	UNI EN 1026:2001
Wind load resistance Class C1	UNI EN 12211:2001
Driving rain tightness Class 4A	UNI EN 1027:2001

### GLASS 4-15-4 BE GAS

U<sub>g</sub> value - W/m<sup>2</sup>K EN673 = 1.0  
Solar Factor - g (%) EN410 = 52.8  
Weighted sound reduction R<sub>w</sub> - is [dB] = NDP

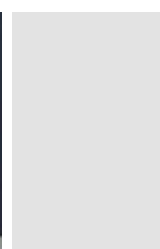

## The 5000 Series

combines the high-quality of an aluminium frame with an affordable price tag. An excellent window-to-floor-area ratio is the main strength of this door.

**GOLD**  
infissi

# WINDOWS

## 5000 SERIES

THERMAL TRANSMITTANCE $\frac{W}{m^2K}$	
<b>U<sub>f</sub></b>	<b>1.30</b>

### RESISTANCE CLASSES

Air permeability Class 2	UNI EN 1026:2001
Wind load resistance Class C1	UNI EN 12211:2001
Driving rain tightness Class 4A	UNI EN 1027:2001

### GLASS 4-15-4 BE GAS

U <sub>g</sub> value - W/m <sup>2</sup> K EN673 = 1.0
Solar Factor - g (%) EN410 = 52.8
Weighted sound reduction R <sub>w</sub> - is [dB] = NDP

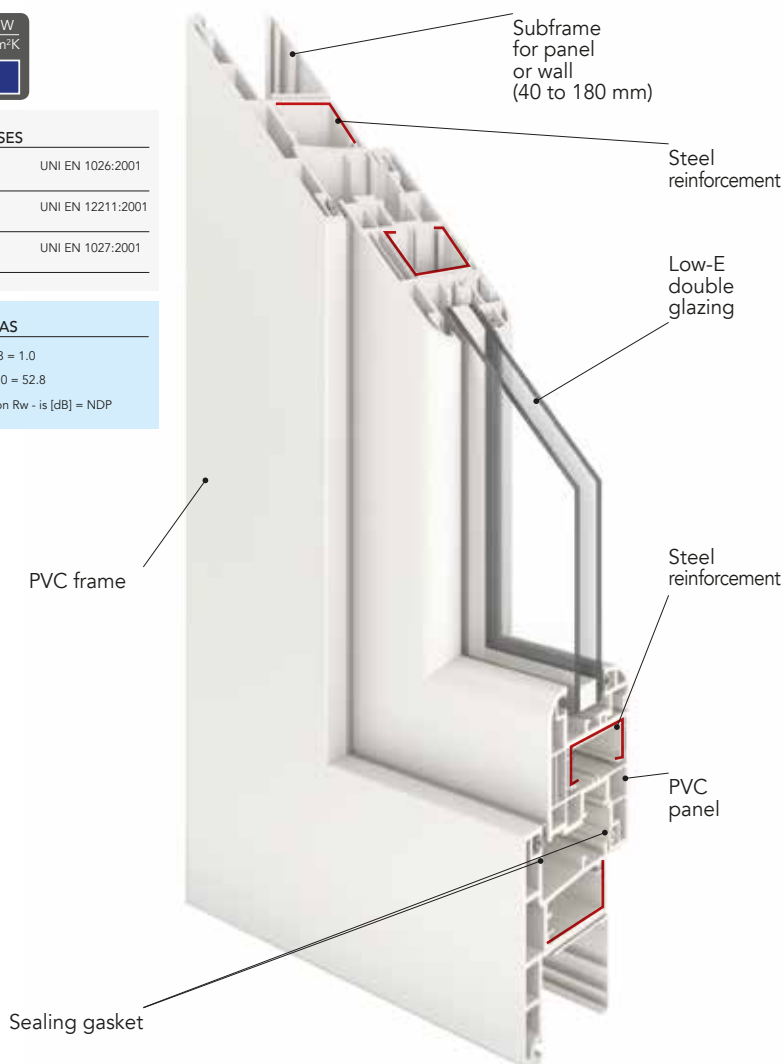

### TECHNICAL FEATURES

Large window

Good value for money

Rugged and durable with reinforced profiles



### The 5000 Series

combines the high-quality of an aluminium frame with an affordable price tag. An excellent window-to-floor-area ratio is the main strength of this door.



Applications:

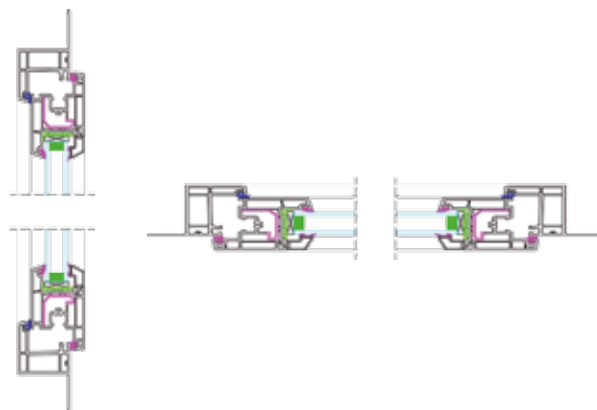

Accessories:



### Description

PVC bottom-hung windows are suitable for use in bathrooms as well as for applications requiring gentle ventilation.

### Technical details:

- Sealing system with panel and frame seal;
- Frame can be installed on either the inner or the outer side;
- Frame and panel are joined with galvanised steel brackets;
- Glass thickness can range from 4 to 26mm;
- Protection bars and/or a fixed insect screen can be installed on request;
- Profile surfaces are oxidised or powder coated - both treatments are QUALANOD/QUALICOAT certified;
- Nylon ratchet (as a standard) - also available in aluminium on request;
- Can be installed on 30 to 180mm thick walls with extruded aluminium subframe;
- A pre-pressed pre-painted aluminium sheet steel intrados is supplied for wall thicknesses greater than 180mm.



Applications:

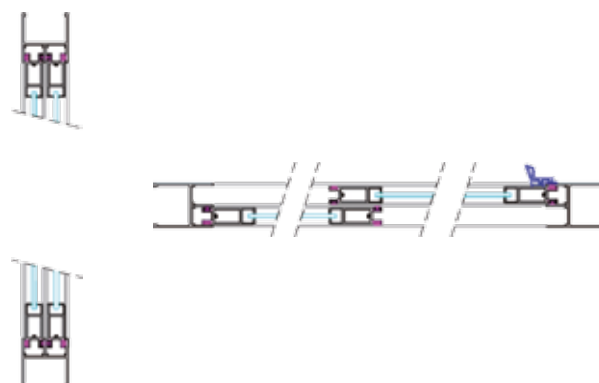

Accessories:



### Description

This window is used to increase the window-to-floor-area ratio in rooms that require large glass windows. It adapts to a variety of applications, particularly to small buildings and rooms, as the sliding system does not take up space.

### Technical details:

- Double brush seal on window panels;
- Frame can be installed on either the inner or the outer side;
- The frame is joined with externally-hooked die-cast aluminium brackets, and the panels with a PVC corner carriage system;
- Glass thickness can range from 4 to 23mm;
- Protection bars and/or a fixed, sliding or roller insect screen can be installed on request;
- Profile surfaces are oxidised or powder coated - both treatments are QUALANOD/QUALICOAT certified;
- Nylon pull handle - also available in aluminium on request;
- Can be installed on 30 to 180mm thick walls with extruded aluminium subframe;
- A pre-pressed pre-painted aluminium sheet steel intrados is supplied for wall thicknesses greater than 180mm.



Applications:

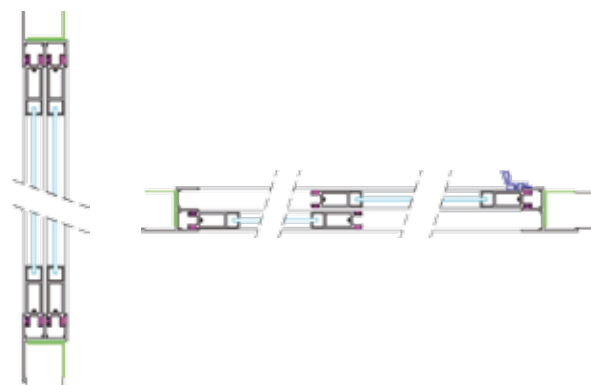

Accessories:



### Description

This window is used to increase the window-to-floor-area ratio in rooms that require large glass windows. It adapts to a variety of applications, particularly to small buildings and rooms, as the sliding system does not take up space.

### Technical details:

- Double brush seal on window panels;
- Frame can be installed on either the inner or the outer side;
- The frame is joined with externally-hooked die-cast aluminium brackets, and the panels with a PVC corner carriage system;
- Glass thickness can range from 4 to 23mm;
- Protection bars and/or a fixed, sliding or roller insect screen can be installed on request;
- Profile surfaces are oxidised or powder coated - both treatments are QUALANOD/QUALICOAT certified;
- Nylon pull handle - also available in aluminium on request;
- Can be installed on 30 to 180mm thick walls with extruded aluminium subframe;
- A pre-pressed pre-painted aluminium sheet steel intrados is supplied for wall thicknesses greater than 180mm.



Applications:

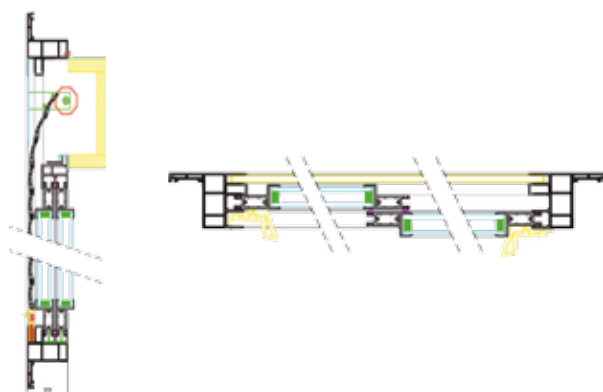

Accessories:



#### Description

A sliding window with roller shutters can make rooms completely dark; it is ideal for dormitories, schools, and offices. It is also particularly suitable for small buildings and rooms, as the sliding system does not take up space inside or outside.

#### Technical details:

- Double brush seal on window panels;
- Frame can be installed on either the inner or the outer side;
- The frame is joined with externally-hooked die-cast aluminium brackets, and the panels with a PVC corner carriage system;
- Glass thickness can range from 4 to 23mm;
- Protection bars and/or a fixed, sliding or roller insect screen can be installed on request;
- Profile surfaces are oxidised or powder coated - both treatments are QUALANOD/QUALICOAT certified;
- Nylon pull handle - also available in aluminium on request;
- Can be installed on 30 to 180mm thick walls with extruded aluminium subframe;
- A pre-painted aluminium sheet steel intrados is supplied for wall thicknesses greater than 180mm.



Applications:

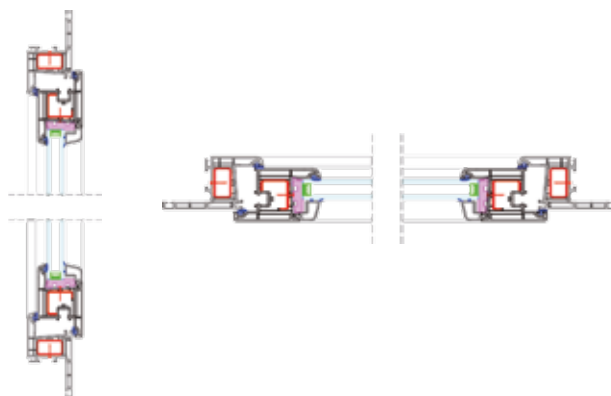

Accessories:



### Description

"Tilt-and-turn" is the most versatile opening system in any application, as it creates two opening positions - a swing window and a bottom-hung window.

### Technical details:

- Sealing system with panel and frame bulb attachment;
- Frame can be installed on either the inner or the outer side;
- Frame and panels are joined with externally-hooked die-cast aluminium brackets;
- Glass thickness can range from 4 to 30mm;
- Protection bars and/or a fixed or roller insect screen can be installed on request;
- Profile surfaces are oxidised or powder coated - both treatments are QUALANOD/QUALICOAT certified;
- Aluminium handle;
- Can be installed on 30 to 180mm thick walls with extruded aluminium subframe;
- A pre-pressed pre-painted aluminium sheet steel intrados is supplied for wall thicknesses greater than 180mm.

# 5000 SERIES

## mod. 5000.06

### Tilt-and-turn window with roller shutters



Applications:

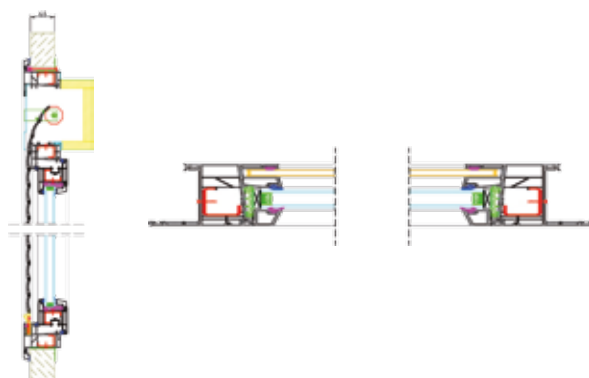

Accessories:



#### Description

This PVC tilt-and-turn window has been designed for new or existing exterior and interior applications, as well as temporary buildings.

Rugged and practical with two opening positions, this window is highly versatile in every application; in addition, a roller shutter completes it with additional functionality by making rooms completely dark when necessary. Suitable for offices, dormitories and schools.

#### Technical details:

- Sealing system with panel and frame bulb attachment;
- Frame installed on the outer side;
- Frame and panels are joined with externally-hooked die-cast aluminium brackets;
- Glass thickness can range from 4 to 30mm;
- Protection bars and/or a fixed or roller insect screen can be installed on request;
- Profile surfaces are oxidised or powder coated - both treatments are QUALANOD/QUALICOAT certified;
- Aluminium handle;
- Roller shutter with 8x37 PVC profile (aluminium roller shutters can be installed on request)
- Can be installed on 30 to 200mm thick walls with extruded aluminium subframe;
- A pre-pressed pre-painted aluminium sheet steel intrados is supplied for wall thicknesses greater than 200mm.



Applications:

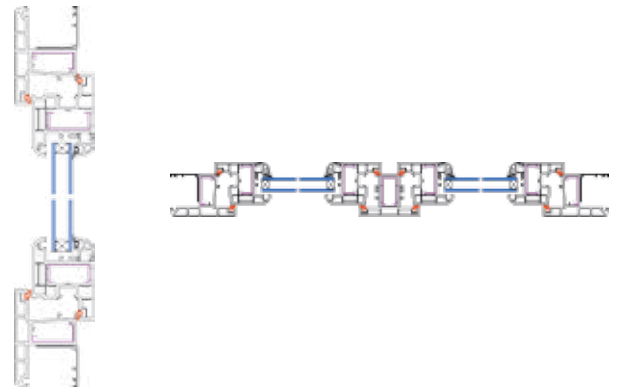

#### Description

"Tilt-and-turn" is the most versatile opening system in any application, as it creates two opening positions - a swing window and a bottom-hung window.

This window is used to increase the window-to-floor-area ratio in rooms that require large glass windows.

#### Technical details:

- 6060 extruded aluminium alloy profiles (EN 573-3);
- Sealing system with panel and frame bulb attachment;
- Frame installed on the outer side;
- Frame and panels are hot rolled;
- Glass thickness can range from 4 to 30mm;
- Protection bars and/or a fixed or roller insect screen can be installed on request;
- Profile surfaces are oxidised or powder coated - both treatments are QUALANOD/QUALICOAT certified;
- Aluminium handle;
- Can be installed on 30 to 200mm thick walls with extruded aluminium subframe;
- A pre-pressed pre-painted aluminium sheet steel intrados is supplied for wall thicknesses greater than 200mm.

#### Certifications:

- Design and production of aluminium doors and windows; third-party processing of aluminium parts (ISO 9001:2008);
- CE marking according to construction products regulation 305/2011/CE.

# 5000 SERIES

## mod. 5000.08

### Tilt-and-turn double window with roller shutter



Applications:

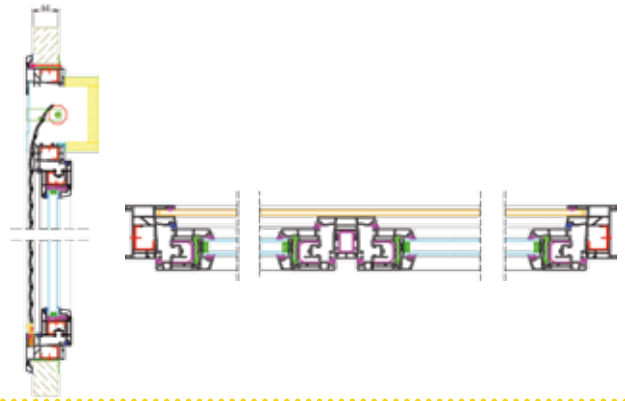

Accessories:



#### Description

This PVC tilt-and-turn window has been designed for new or existing exterior and interior applications, as well as temporary buildings. It is a practical, rugged window. The dual opening position makes it highly versatile in any application, while the roller shutter adds functionality by making the room completely dark where required. Suitable for offices, dormitories and schools.

#### Technical details:

- Sealing system with panel and frame bulb attachment;
- Frame installed on the outer side;
- Frame and panels are joined with externally-hooked die-cast aluminium brackets;
- Glass thickness can range from 4 to 30mm;
- Protection bars and/or a fixed or roller insect screen can be installed on request;
- Profile surfaces are oxidised or powder coated - both treatments are QUALANOD/QUALICOAT certified;
- Aluminium handle;
- Roller shutter with 8x37 PVC profile (aluminium roller shutters can be installed on request)
- Can be installed on 30 to 200mm thick walls with extruded aluminium subframe;
- A pre-pressed pre-painted aluminium sheet steel intrados is supplied for wall thicknesses greater than 200mm.

# 5000 SERIES

## mod. 5000.09

Double window, with one fixed panel and one tilt-and-turn panel



Applications:

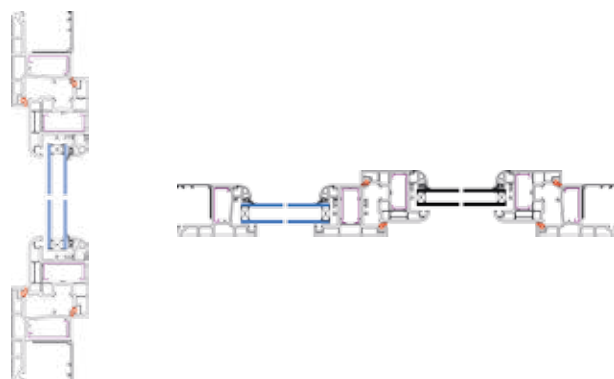

### Description

This window is used to increase the window-to-floor-area ratio in rooms that require large glass windows.

"Tilt-and-turn" is the most versatile opening system in any application, as it creates two opening positions - a swing window and a bottom-hung window.

### Technical details:

- 6060 extruded aluminium alloy profiles (EN 573-3);
- Sealing system with panel and frame bulb attachment;
- Frame installed on the outer side;
- Frame and panels are hot rolled;
- Glass thickness can range from 4 to 30mm;
- Protection bars and/or a fixed or roller insect screen can be installed on request;
- Profile surfaces are oxidised or powder coated - both treatments are QUALANOD/QUALICOAT certified;
- Aluminium handle;
- Can be installed on 30 to 200mm thick walls with extruded aluminium subframe;
- A pre-pressed pre-painted aluminium sheet steel intrados is supplied for wall thicknesses greater than 200mm.

### Certifications:

- Design and production of aluminium doors and windows; third-party processing of aluminium parts (ISO 9001:2008);
- CE marking according to construction products regulation 305/2011/CE.



# 5000 SERIES

## mod. 5000. 10

Double window, with one fixed panel and one tilt-and-turn panel, with roller shutter



Applications:

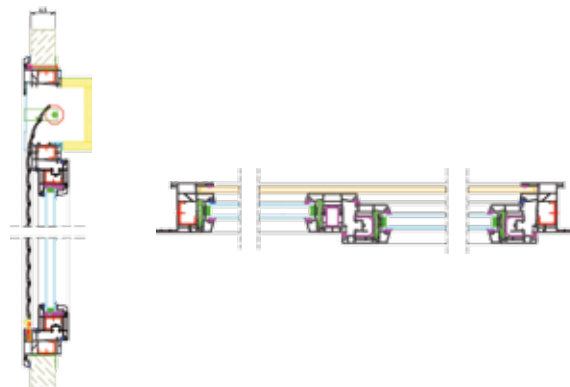

Accessories:



### Description

This PVC tilt-and-turn window has been designed for new or existing exterior and interior applications, as well as temporary buildings. It is a practical, rugged window. The dual opening position makes it highly versatile in any application, while the roller shutter adds functionality by making the room completely dark where required. Suitable for offices, dormitories and schools.

### Technical details:

- Sealing system with panel and frame bulb attachment;
- Frame installed on the outer side;
- Frame and panels are joined with externally-hooked die-cast aluminium brackets;
- Glass thickness can range from 4 to 30mm;
- Protection bars and/or a fixed or roller insect screen can be installed on request;
- Profile surfaces are oxidised or powder coated - both treatments are QUALANOD/QUALICOAT certified;
- Aluminium handle;
- Roller shutter with 8x37 PVC profile (aluminium roller shutters can be installed on request)
- Can be installed on 30 to 200mm thick walls with extruded aluminium subframe;
- A pre-pressed pre-painted aluminium sheet steel intrados is supplied for wall thicknesses greater than 200mm.



Applications:

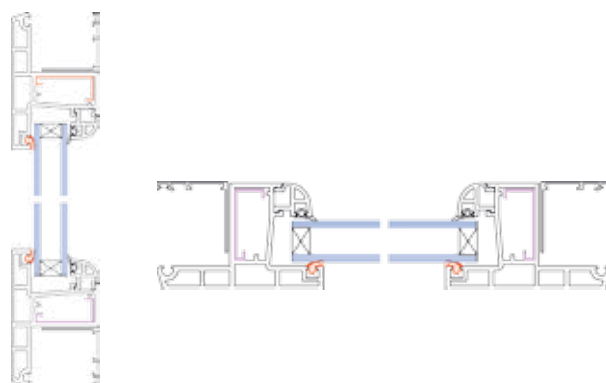

### Description

This window has been designed to make rooms brighter.

### Technical details:

- 6060 extruded aluminium alloy profiles (EN 573-3);
- Frame can be installed on either the inner or the outer side;
- The frame is hot rolled;
- Glass thickness can range from 4 to 30mm;
- Protection bars can be installed on request;
- Profile surfaces are oxidised or powder coated - both treatments are QUALANOD/QUALICOAT certified;
- Can be installed on 30 to 180mm thick walls with extruded aluminium subframe;
- A pre-pressed pre-painted aluminium sheet steel intrados is supplied for wall thicknesses greater than 180mm.

### Certifications:

- Design and production of aluminium doors and windows; third-party processing of aluminium parts (ISO 9001:2008);
- CE marking according to construction products regulation 305/2011/CE.

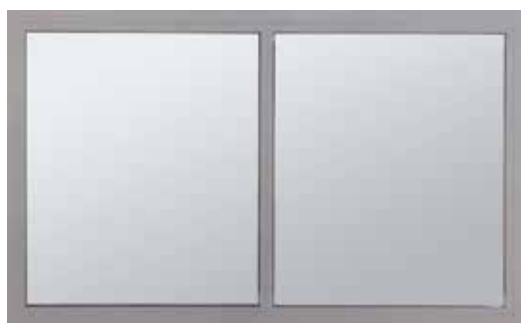

Applications:

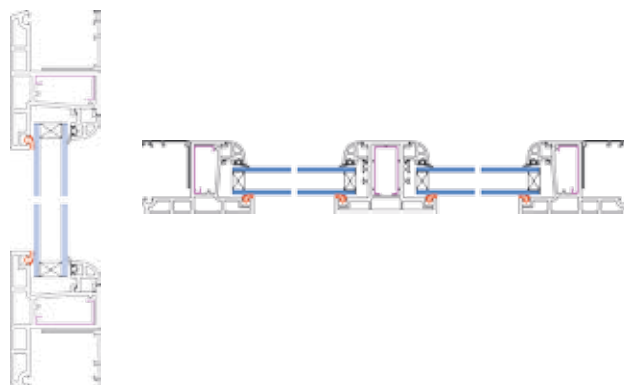

#### Description

This window has been designed to make rooms brighter.

The double fixed window is used to increase the window-to-floor-area ratio in rooms that require large glass windows.

#### Technical details:

- 6060 extruded aluminium alloy profiles (EN 573-3);
- Frame can be installed on either the inner or the outer side;
- The frame is hot rolled;
- Glass thickness can range from 4 to 30mm;
- Protection bars can be installed on request;
- Profile surfaces are oxidised or powder coated - both treatments are QUALANOD/QUALICOAT certified;
- Can be installed on 30 to 180mm thick walls with extruded aluminium subframe;
- A pre-pressed pre-painted aluminium sheet steel intrados is supplied for wall thicknesses greater than 180mm.

#### Certifications:

- Design and production of aluminium doors and windows; third-party processing of aluminium parts (ISO 9001:2008);
- CE marking according to construction products regulation 305/2011/CE.

## Aluminium RAL range

Available on request

RAL 1011	RAL 1019	RAL 1033	RAL 2009	RAL 3004	RAL 3015
RAL 1012	RAL 1020	RAL 1034	RAL 2010	RAL 3005	RAL 3016
RAL 1013	RAL 1021	RAL 2000	RAL 2011	RAL 3007	RAL 3017
RAL 1014	RAL 1023	RAL 2001	RAL 2012	RAL 3009	RAL 3018
RAL 1015	RAL 1024	RAL 2002	RAL 3000	RAL 3011	RAL 3020
RAL 1016	RAL 1027	RAL 2003	RAL 3001	RAL 3012	RAL 3022
RAL 1017	RAL 1028	RAL 2004	RAL 3002	RAL 3013	RAL 3027
RAL 1018	RAL 1032	RAL 2008	RAL 3003	RAL 3014	RAL 3031

RAL 4009	RAL 5008	RAL 5017	RAL 6000	RAL 6008	RAL 6016
RAL 5000	RAL 5009	RAL 5018	RAL 6001	RAL 6009	RAL 6017
RAL 5001	RAL 5010	RAL 5019	RAL 6002	RAL 6010	RAL 6018
RAL 5002	RAL 5011	RAL 5020	RAL 6003	RAL 6011	RAL 6019
RAL 5003	RAL 5012	RAL 5021	RAL 6004	RAL 6012	RAL 6020
RAL 5004	RAL 5013	RAL 5022	RAL 6005	RAL 6013	RAL 6021
RAL 5005	RAL 5014	RAL 5023	RAL 6006	RAL 6014	RAL 6022
RAL 5007	RAL 5015	RAL 5024	RAL 6007	RAL 6015	RAL 6024

RAL 7000	RAL 7009	RAL 7022	RAL 7034	RAL 7043	RAL 8008
RAL 7001	RAL 7010	RAL 7023	RAL 7035	RAL 7044	RAL 8011
RAL 7002	RAL 7011	RAL 7024	RAL 7036	RAL 8000	RAL 8012
RAL 7003	RAL 7012	RAL 7026	RAL 7037	RAL 8001	RAL 8014
RAL 7004	RAL 7013	RAL 7030	RAL 7038	RAL 8002	RAL 8015
RAL 7005	RAL 7015	RAL 7031	RAL 7039	RAL 8003	RAL 8016
RAL 7006	RAL 7016	RAL 7032	RAL 7040	RAL 8004	RAL 8017
RAL 7008	RAL 7021	RAL 7033	RAL 7042	RAL 8007	RAL 8019

RAL 8028	RAL 9003	RAL 9011
RAL 9000	RAL 9004	RAL 9016
RAL 9001	RAL 9005	RAL 9017
RAL 9002	RAL 9010	RAL 9018

# Painted PVC RAL range

Available on request

## COLOURS

RAL 1002	RAL 1015	RAL 1016	RAL 2004	RAL 3003	RAL 3005
RAL 5007	RAL 5010	RAL 5013	RAL 6005	RAL 6016	RAL 6027
RAL 7000	RAL 7001	RAL 7002	RAL 7003	RAL 7016	RAL 7039
RAL 8003	RAL 8017	RAL 9006	1035 PERL	5026 PERL	6036 PERL

Other colours are available on request, but we do not guarantee their resistance over time.



**[www.goldinfissi.com](http://www.goldinfissi.com)**

Created by:  
Gold Infissi Marketing Office / Studio OK Padua





Via Frattina, 51 - 35011 Campodarsego (PD) - Italy  
Tel. +39.049.9201111 - Fax +39.049.9201112  
**[www.goldinfissi.com](http://www.goldinfissi.com) - [info@goldinfissi.com](mailto:info@goldinfissi.com)**